

COMPONENT PARTS CATALOG

for

REVERSE



POWER LAWN MOWERS

25" AND 30" SINGLE UNIT

70" AND 75" TRIPLEX

JUNE 1966

Manufactured by

LOCKE DEVERE DIVISION

LOCKE MANUFACTURING COMPANIES, INC.

BRIDGEPORT, CONN. 06601

PART NO. 2287

Price \$1.00



POWER LAWN MOWERS

SINGLE UNITS, 25 AND 30 INCH CUT
TRIPLEX, - - 70 AND 75 INCH CUT

COMPONENT PARTS CATALOG

REVERSE MACHINE

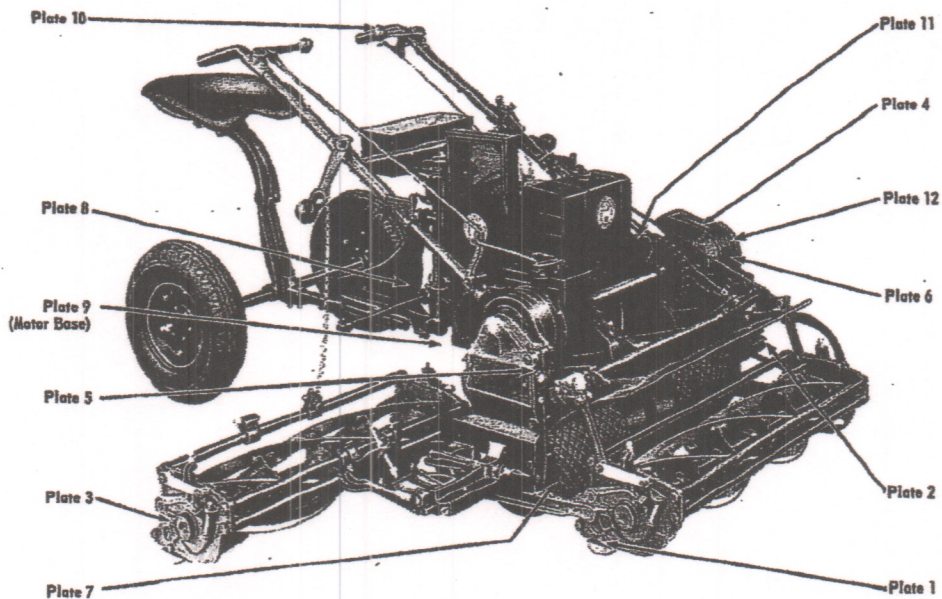

JUNE 1966

ORDERING INSTRUCTIONS

ALWAYS GIVE SERIAL NUMBER OF MOWER WHEN ORDERING PARTS. THE RIGHT AND LEFT HAND SIDE OF THE MACHINE ARE DETERMINED FROM THE OPERATOR'S POSITION. REFER TO SERIAL NUMBER.

LOCKE DEVERE DIVISION

LOCKE MANUFACTURING COMPANIES, INC.

BRIDGEPORT, CONN. 06601

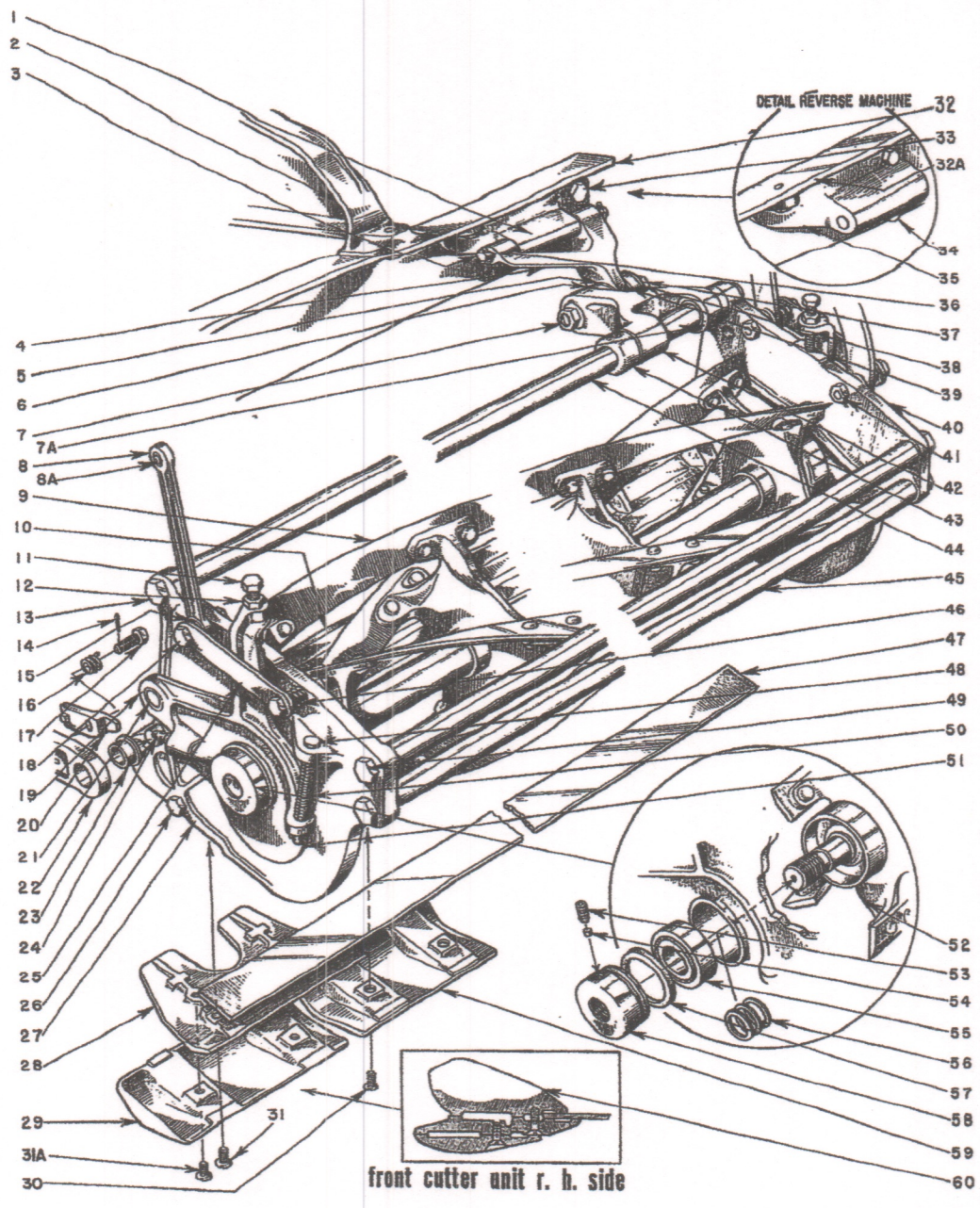

parts list number 1

KEY NO.	PART NO.	PART NAME	DESCRIPTION
1	1788	Front Cutting Unit Sway Control Mounting Bracket - Plain Machine	
2	1633	Motor Chain Guard Bracket - 70" Reverse Only	
	1633-1	Motor Chain Guard Bracket - For All Other Mowers	
3	1791	Front Cutting Unit Sway Control Hinge Pin	
4	1787	Front Cutting Unit Sway Control Link to Frame	
		Includes 2 - #1790 Bronze Bushings	
5	1796	Front Cutting Unit Sway Control Friction Washer,	7/16 x 1 x 1/16 Brass
6	1797	Front Cutting Unit Sway Control Rubber Washer	
7	724	Hex. Nut	3/8 - 24
7A	1792-1	Bronze Bushing	
8	905	Cutter Carrying Link R.H.	Includes 2 - #2116 Steel Bushings
9	867	25" Cutter Reel and Shaft Assembly - 5 Blade; 2113 - 6 Blade; 1486 - 3 Blade	
	1135	30" Cutter Reel and Shaft Assembly - 5 Blade; 2114 - 6 Blade; 1487 - 3 Blade	
10	1216	30" Blade Back	
	1221	25" Blade Back	
11	767	Cap Screw	5/16 - 24 x 1 1/2 Hex. Head
12	744	Hex. Nut	5/16 - 24
13	1056	Bolt	1/2 - 20 x 1 1/4
14	1893	Cotter Pin	3/32 x 1/2
15	729	Spring	9/16 x 3/8
16	729	Spring	9/16 x 3/8
17	904	Cap Screw	5/16 - 24 x 3/4 Hex. Head Drilled and Slotted
18	892	Cap Screw	3/8 - 24 x 1 1/2 Hex. Head
19	889-1	Cutter Reel Bearing Bracket R.H. - Malleable Iron	Includes 1 - #1340N Nylon Bushing
20	903	Cutter Unit Distance Link Strap	
21	1340N	Bushing - Nylon	
22	901	Cutter Unit Distance Link R.H.	
		Includes 2 - #1340N Nylon Bushing	
23	1340N	Bushing - Nylon	
24	1879	Hydraulic Fitting Alemite #A-1641 or Lincoln #5010	
25	891	Cutter Reel Bearing Bracket Strap	
26	820	Cap Screw	3/8 - 24 x 1 1/4 Hex. Head
27	887-2	Cutter Side Plate R.H.	
		Includes 1 - #817-2	
28	1841	Gauge Shoe Shim 1/2" R.H.	
	1842	Gauge Shoe Shim 1/2" L.H.	
29	1312-1	Iron Gauge Shoe - R.H. 1/2" Cut	
	1315-1	Iron Gauge Shoe - R.H. 3/4" Cut	
	1318-1	Iron Gauge Shoe - R.H. 1" Cut	
	1321-1	Iron Gauge Shoe - R.H. 1 1/4" Cut	
	1390-1	Iron Gauge Shoe - R.H. 1 1/2" Cut	
	1392-1	Iron Gauge Shoe - R.H. 2" Cut	
	1313-1	Iron Gauge Shoe - L.H. 1/2" Cut	
	1316-1	Iron Gauge Shoe - L.H. 3/4" Cut	
	1319-1	Iron Gauge Shoe - L.H. 1" Cut	
	1322-1	Iron Gauge Shoe - L.H. 1 1/4" Cut	
	1391-1	Iron Gauge Shoe - L.H. 1 1/2" Cut	
	1393-1	Iron Gauge Shoe - L.H. 2" Cut	
30	884-7/8	Gauge Shoe Screw	5/16 - 18 x 7/8 Flat Head Zinc Plated

*Bronze Shoes are available at extra cost

*Standard height of cut is 1 1/4", using 1 - #1841 and 1842 - 1/2" Gauge Shoe Shim and 1 - #1315 and 1316 - 3/4" and Gauge Shoe. Other heights of cut are special.



parts list number 1

KEY NO.	PART NO.	PART NAME	DESCRIPTION
31	885	Gauge Shoe Screw	5/16 - 18 x 1 1/8 Flat Head Zinc Plated
31A	884-3/4	Gauge Shoe Screw	5/16 - 18 x 3/4
32	1153-X	Tractor Cross Frame - Front 75" or 30" - Plain Machine	
	799-X	Tractor Cross Frame - Front 70" or 25" - Plain Machine	
32A	1572	Tractor Cross Frame - Front 75" - Reverse Machine	
	1636	Tractor Cross Frame - Front 70" - Reverse Machine	
33	708	Cap Screw	3/8 - 24 x 1 Hex. Head
34	820	Front Cutter Unit Sway Control Mounting Bolts	3/8 - 24 x 1 1/4 Hex Cap
35	1785	Front Cutter Unit Sway Control Mounting Bracket - Reverse	
36	1790	Front Cutter Unit Sway Control Link Bushing	
37	1795	Front Cutter Unit Sway Control Pivot Stud	
38	1797	Front Cutter Unit Sway Control Rubber Washer	
39	1796	Front Cutter Unit Sway Control Friction Washer - Brass	
40	888-2	Cutter Side Plate L.H.	
		Includes 1 - #817-2	
41	724-J	Hex. Nut	3/8 - 24 Jam
42	1786-1	Front Cutter Unit Sway Control Link to Unit	
		Includes 2 - #1792-1 Bronze Bushing	
43	1798	Front Cutter Unit Sway Control Stop Collar and Set Screw	
44	1793-1	Front Cutter Unit Sway Control Rear Spacer Bar 25" use with 1792-1 Bushing	
	1794-1	Front Cutter Unit Sway Control Rear Spacer Bar 30" use with 1792-1 Bushing	
45	900-X	25" Cutter Unit Spacer Bar	
	1143-X	30" Cutter Unit Spacer Bar	
46	787	Spring	5/8 x 7 3/8 (60#)
47	877	Stationary Blade	1 3/8 x 1 1/4 x 25 5/8
	1137	Stationary Blade	1 3/8 x 1 1/4 x 30 5/8
48	895-1	Cutter Reel Pressure Spring Pin	
49	1056	Bolt	1/2 - 20 x 1 1/4
50	894	Cutter Reel Pressure Spring	
51	1893	Cutter Pin	3/32 x 1 2
52	867	25" Cutter Reel and Shaft Assembly 5 Blade	
	1135	30" Cutter Reel and Shaft Assembly 5 Blade	
53	761	Set Screw - Cup Point	5/16 - 24 x 7/16
54	762	Set Screw Slug - Brass	
55	869	Ball Bearing - Single Felt Seal	
56	1310	Cutter Reel Ball Bearing Shim	.100" Thick
	870	Cutter Reel Ball Bearing Shim	.116" Thick
	871	Cutter Reel Ball Bearing Shim	.132" Thick
	872	Cutter Reel Ball Bearing Shim	.110" Thick
	873	Cutter Reel Ball Bearing Shim	.095" Thick
57	848	Felt	1 7/8 x 1 1/2 x 3/16
58	875	Cutter Reel Ball Bearing Lock Nut R.H. Thread	
*59	1311-1	Iron Gauge Shoe - Center 1.2" Cut	
	1314-1	Iron Gauge Shoe - Center 3/4" Cut	
	1317-1	Iron Gauge Shoe - Center 1" Cut	
	1320-1	Iron Gauge Shoe - Center 1 1/4" Cut	
60	1216	30" Blade Back	
	1221	25" Blade Back	

*Bronze Shoes are available at extra cost

*Standard height of cut is 1 1/4", using 1 - #1841 and 1842 - 1/2" Gauge Shoe Shim and 1 - #1315 and 1316 - 3/4" end Gauge Shoe. Other heights of cut are special.



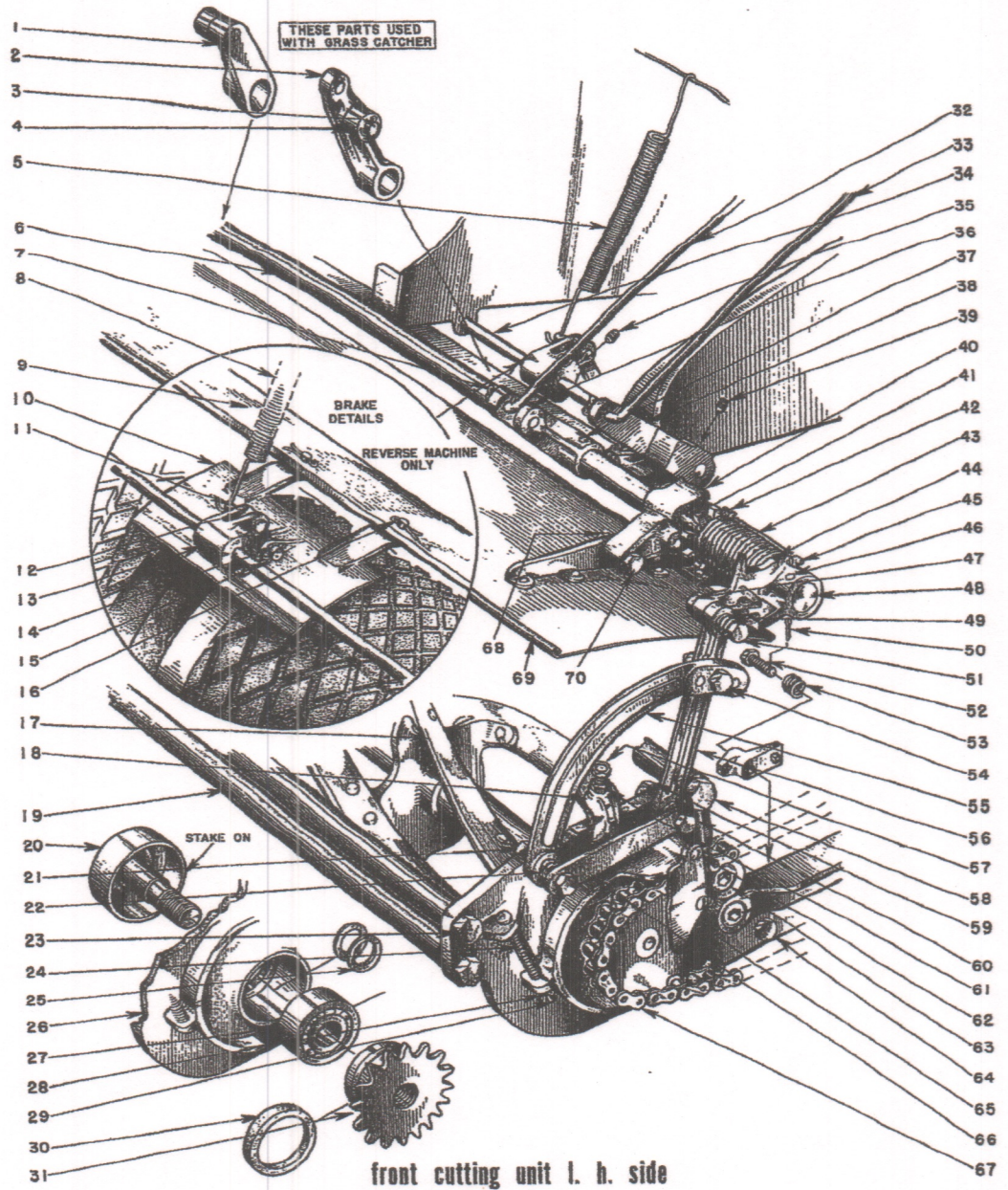

parts list number 2

KEY NO.	PART NO.	PART NAME	DESCRIPTION
1	1052	Grass Box Lifting Lever	
2	1051	Cutter and Grass Box Lifting Lever	
3	1058	Groov Pin-Drilled	3/8 x 1 1/4
4	1057	Grass Box Lifting Lever Roll	
5	2142	Parking Brake Spring -- Reverse Machine	
6	913	Front Cutting Unit Lifting Shaft 25" and 70" Plain Machine	
	1152	Front Cutting Unit Lifting Shaft 30" and 75" Plain Machine	
	1836	Front Cutting Unit Lifting Shaft 70" Reverse Machine	
	1837	Front Cutting Unit Lifting Shaft 75" Reverse Machine	
7	1893	Cotter Pin	3/32 x 1/2
8	2142	Parking Brake Spring -- Reverse Machine	
9	1637	Tractor Cross Frame -- 70" Rear Reverse Machine	
	1573	Tractor Cross Frame -- 75" Rear Reverse Machine	
10	1680-A	Brake Shoe Assembly -- Reverse Machine	
11	1679	Brake Clevis Pin	
12	1677	Brake Link	
13	1674	Brake Link Lever	
14	1679	Brake Clevis Pin	
15	1893	Cotter Pin	3/32 x 1/2
16	1893	Cotter Pin	3/32 x 1/2
17	867	25" Cutter Reel and Shaft Assembly -- 5 Blade	
	1135	30" Cutter Reel and Shaft Assembly -- 5 Blade	
18	2056-2	Cutter Reel Bearing Bracket -- L.H. Malleable Iron -- Includes 1 -- #1340N Bushing	
19	900-X	25" Cutter Unit Spacer Bar	
	1143-X	30" Cutter Unit Spacer Bar	
20	876	Cutter Reel Bearing Guard Cup	
21	724-J	Hex. Nut	3/8 - 24 Jam
22	729	Spring	9/16 x 3/8
23	1056	Bolt	1/2 - 20 x 1 1/4
24	894	Cutter Reel Pressure Spring	
25	1310	Cutter Reel Ball Bearing Shim	.100" Thick
	870	Cutter Reel Ball Bearing Shim	1/16" Thick
	871	Cutter Reel Ball Bearing Shim	1/32" Thick
	872	Cutter Reel Ball Bearing Shim	.010" Thick
	873	Cutter Reel Ball Bearing Shim	.005" Thick
26	888-2	Cutter Side Plate L.H. -- Includes 1 -- #817-2 Stud	
27	869	Ball Bearing -- Single Felt Seal	
28	1893	Cotter Pin	3/32 x 1/2
29	895-1	Cutter Reel Pressure Spring Pin	
30	848	Felt	1 7/8 x 1 1/2 x 3/16
31	1238	Reel Sprocket 17T. Heavy Duty Used With No. 514 Chain	
32	2110	Front Cutting Unit Elevating Rod -- For 25" and 70" Plain	
	2111	Front Cutting Unit Elevating Rod -- For 30" with 14R6 Motor	
	1761	Front Cutting Unit Elevating Rod -- For Reverse Machines	



parts list number 2

KEY NO.	PART NO.	PART NAME	DESCRIPTION
33	1762	Tractor Brake Rod - Reverse Machine	
34	1678	Brake Shaft - Reverse Machine	
35	761	Set Screw	5/16 - 24 x 7/16 Cup Point
36	1051	Cutter and Grass Box Lifting Lever	
37	703	Groov Pin	3/16 x 1 1/4
38	1754	Brake Lever - Reverse Machine	
39	761	Set Screw	5/16 - 24 x 7/16 Cup Point,
40	758-X	Clutch Shaft Bracket L.H. - Plain Machine	
	757-X	Clutch Shaft Bracket R.H. - Plain Machine	
	1523	Clutch Shaft Bracket L.H. - Reverse Machine	
	1571	Front Cutter Lifting Lever Bracket - Reverse Machine	
41	912	Cutter Lifting Spring Tension Collar Key	
	1893	Cotter Pin	3/32 x 1/2
42	911	Cutter Lifting Spring Tension Collar	
43	910	Cutter Lifting Spring L.H.	
	909	Cutter Lifting Spring R.H.	
44	908-AR	Spring Tension Cutter Lifting Lever R.H.	
	908-AL	Spring Tension Cutter Lifting Lever L.H.	
45	1879	Hydraulic Fitting Alemite #A-1641 or Lincoln #5010	
46	703	Groov Pin	3/16 x 1 1/4
47	724	Nut	3/8 - 24 Hex
48	915	Cutter Lifting Dog	
49	729	Spring	9/16 x 3/8
50	1893	Cotter Pin	
51	892	Cap Screw	3/8 - 24 x 1 1/2 Hex. Head
52	904	Screw - Drilled and Slotted	5/16 - 24 x 7/8 Hex. Head
53	729	Spring	9/16 x 3/8
54	708	Cap Screw	3/8 - 24 x 1 Hex. Head
55	907	Front Cutter Adjusting Segment	
		Includes 1 - #2116 Steel Bushing	
56	906	Front Cutter Carrying Link L.H.	
		Includes 2 - #2116 Steel Bushings	
57	767	Cap Screw	5/16 - 24 x 1 1/2 Hex. Head
58	1056	Bolt	1/2 - 20 x 1 1/4
59	724-J	Hex. Nut	3/8 - 24 Jam
60	892	Cap Screw	3/8 - 24 x 1 1/2 Hex. Head
61	744	Nut	5/16 - 24 Hex.
62	1409	Round Head Screw	1/4 - 28 x 5/8
63	817-2	Stud, Special Socket Head	3/8-24 x 1/2
64	820	Cap Screw	3/8 - 24 x 1 1/4 Hex. Head
65	2059-1	Cutter Reel Bearing Bracket Chain Guard	Used with 2056-2
	2059	Cutter Reel Bearing Bracket Chain Guard	Used with 2056-D and Old Style 2056-1
66	891	Cutter Reel Bearing Bracket Strap	
67	1744	Cutter Chain - Reverse Mowers except 10X	1/2 x 1/4 x .335 - 63 1/2" Long #514
	1258	Cutter Chain 25" Heavy Duty and 30" Mowers	1/2 x 1/4 x .335 - 60 1/2" Long #514
	1263	Cutter Chain Plain Triplex Mowers & Item 10X	1/2 x 1/4 x .335 - 64" Long # 514
68	1861	Lock Nut	5/16 - 24
69	916	Grass Guard Assembly 25" and 70"	
	1147	Grass Guard Assembly 30" and 75"	
70	746	Screw	5/16 - 24 x 1 Hex. Head



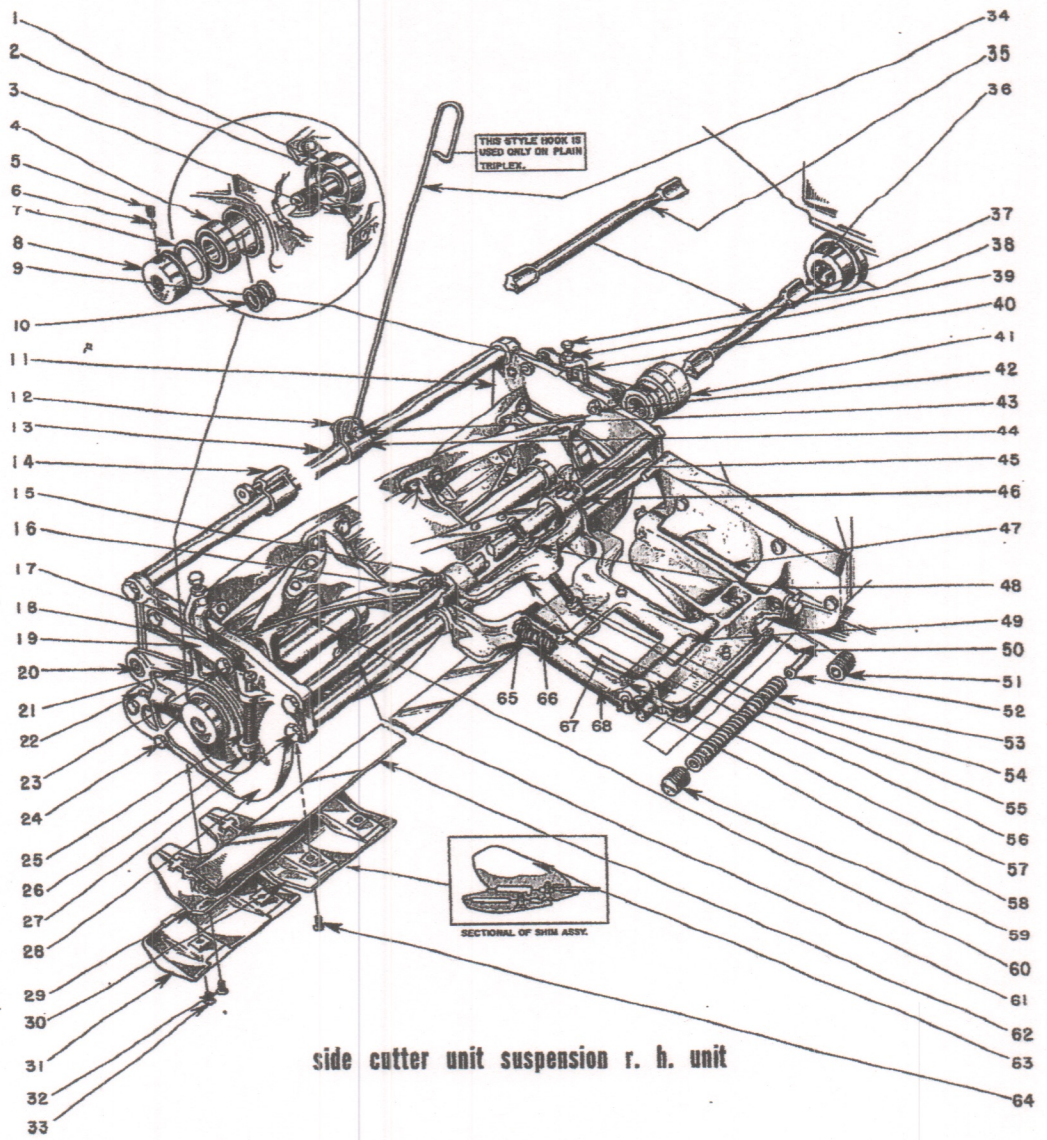

parts list number 3

KEY NO.	PART NO.	PART NAME	DESCRIPTION
1	876	Cutter Reel Bearing Guard Cup	
2	1488	Steel Washer	1 x 1 5/8 x 3/32
	1488-1	Steel Washer	1 x 1 5/8 x 1/16
3	867	25" Cutter Reel and Shaft Assembly - 5 Blade	
4	869	Cutter Reel Ball Bearing - Single Felt Seal	
5	761	Socket Head Set Screw	5/16 - 24 x 7/16 Cup Point
6	762	Set Screw Slug - Brass	
7	848	Felt Washer	1 7/8 x 1 1/2 x 3/16
8	875	Lock Nut R.H. Thread for R.H. Unit	
	990	Lock Nut L.H. Thread for L.H. Unit	
9	848	Felt Washer	1 7/8 x 1 1/2 x 3/16
10	1310	Cutter Reel Ball Bearing Shim	.100" Thick
	870	Cutter Reel Ball Bearing Shim	1/16" Thick
	871	Cutter Reel Ball Bearing Shim	1/32" Thick
	872	Cutter Reel Ball Bearing Shim	.010" Thick
	873	Cutter Reel Ball Bearing Shim	.005" Thick
11	888-2	Cutter Side Plate L.H.	
		Includes 1 - #817-2 Stud	
12	858	Cap Screw	3/8 - 24 x 1 3/4 Hex. Head
13	900-X1	Side Unit Spacer Bar - Drilled with 1 Spot	
14	1010-A	Cutter Elevating Hook Assembly	
		Includes 1 - #1010	
		1 - #1403	
		1 - #1404	
15	761	Socket Head Set Screw	5/16 - 24 x 7/16 Cup Point
16	1008	Side Unit Locating Collar	
17	787	Spring	5/8 x 7/8
18	895-1	Cutter Reel Pressure Spring Pin	
19	891	Cutter Reel Bearing Bracket Strap	
20	1340N	Bushing-Nylon	
21	889-1	Cutter Reel Bearing Bracket Malleable Iron	
		Includes 1 - #1340N Bushing-Nylon	
22	1879	Hydraulic Fitting Alemite #A-1641 or Lincoln #5010	
23	892	Cap Screw	3/8 - 24 x 1 1/2 Hex. Head
24	820	Cap Screw	3/8 - 24 x 1 1/4 Hex. Head
25	894	Cutter Reel Pressure Spring	
26	1891	Cotter Pin	1/16 x 3/8
27	1056	Bolt	1/2 - 20 x 1 1/4 Hex. Head
28	887-2	Cutter Reel Side Plate R.H.	
		Includes 1 - #817-2 Stud	
29	1841	Gauge Shoe Shim 1/2" R.H.	
	1842	Gauge Shoe Shim 1/2" L.H.	
30	1314-1	Iron Gauge Shoe - Center Section 3/4" Cut	
31	1315-1	Iron Gauge Shoe - R.H. 3/4" Cut	
	1316-1	Iron Gauge Shoe - L.H. 3/4" Cut	

*For other height of cut see Plate 1.

*Standard height of cut is 1 1/4", using 1 - #1841 and 1842 - 1/2" Gauge Shoe Shim and 1 - #1315 and 1316 - 3/4" and Gauge Shoe. Other heights of cut are special.



parts list number 3

KEY NO.	PART NO.	PART NAME	DESCRIPTION
32	885	Flat Head Screw	5/16 - 18 x 1 Zinc Plated
33	884-3/4	Flat Head Screw	5/16 - 18 x 3/4 Zinc Plated
34	1061	Side Unit Carrying Hook - Plain Machine	
35	2036	Universal Drive Shaft - 9 1/4 " Long	
36	1012	Universal Drive Socket and Sprocket Shaft R.H. Assembly	
37	1015	Universal Connecting Shaft - 6 7/8 " Long	
38	767	Cap Screw	5/16 - 24 x 1 1/2 Hex. Head
39	744	Hex. Nut	5/16 - 24
40	2056-2	Cutter Reel Bearing Bracket L.H. Malleable Iron Includes 1 - #1340N Bushing Nylon	
41	989	Reel Drive Socket Assembly L.H. Thread (For R.H. Unit) Includes 3 - #991 1/2 " Steel Ball 1 - #992-1 Ball Retainer Cup 1 15/16" I.D.	
	988	Reel Drive Socket Assembly R.H. Thread (For L.H. Unit) Includes 3 - #991 1/2" Steel Ball 1 - #992-1 Ball Retainer Cup 1 15/16" I.D.	
42	724-J	Hex. Nut	3/8 - 24 Jam
43	724	Hex. Nut	3/8 - 24
44	1062	Side Unit Carrying Hook Pivot Clamp	
45	1009	Thumb Screw	5/16 - 24 x 5/8
46	1008	Side Unit Locating Collar	
47	996	Side Unit Pivot Bracket Pivot Pin Includes 1 - #703 Groov-Pin	8 5/16 " Long 3/16 x 1 1/4
48	1860	Hardened Washer	7/8 x 35/64 x 1/8
49	1449	Side Unit Angle Bracket Spacer	1.635" Long
50	1892	Cotter Pin	1/16 x 1/2
51	1004	Side Unit Balancing Spring Pin Bearing	
52	1002-3	Side Unit Balancing Spring Pin and Head Assembly	
53	1001	Side Unit Balancing Spring	
54	724-J	Hex. Nut	3/8 - 24 Jam
55	1007	Screw	3/8 - 24 x 5 1/8
56	1006	Side Unit Cutter Adjusting Bracket	
57	1879	Hydraulic Fitting Alemite #A-1641 or Lincoln #5010	
58	1000	Side Unit Cutter Bracket Pivot Pin	7 " Long
59	1005	Side Unit Balancing Spring Plug	
60	867	25 " Cutter Reel and Shaft Assembly - 5 Blade	
61	900-X6	Side Unit Spacer Bar - Drilled with 6 Spot	
62	877	Stationary Blade - 25"	
63	1221	25" Blade Back	
64	884-7/8	Flat Head Screw	5/16 - 18 x 7/8 Zinc Plated
65	1005	Side Unit Balancing Spring Plug	
66	1001	Side Unit Balancing Spring	
67	997-1	Side Unit Angle Bracket R.H. Assembly Includes 1 - #1448 Stop Bar 1 - #1449 Steel Spacer	
	998-1	Side Unit Angle Bracket L.H. Assembly Includes 1 - #1448 Stop Bar 1 - #1449 Steel Spacer	
68	999	Side Unit Cutter Bracket	



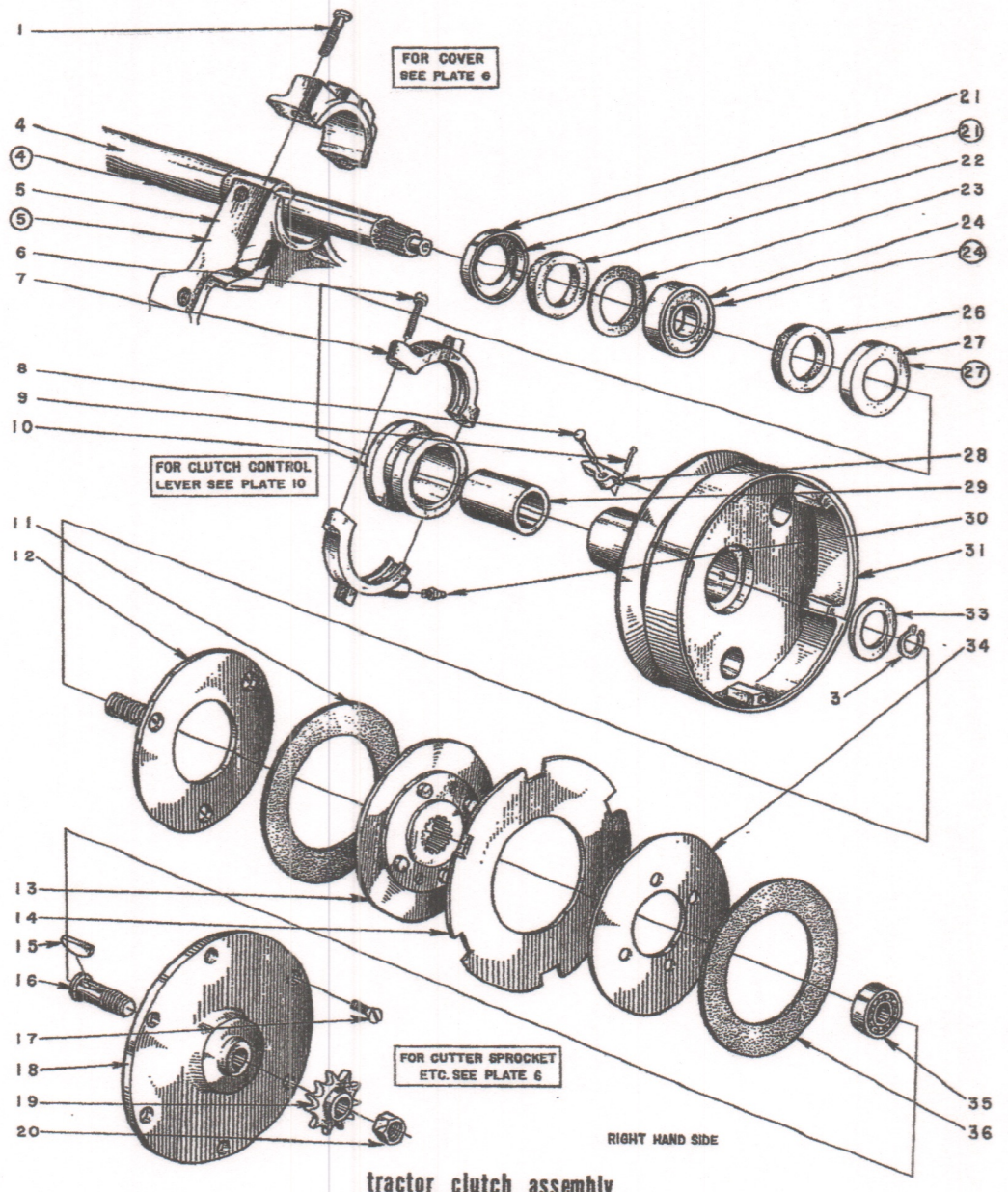

parts list number 4

KEY NO.	PART NO.	PART NAME	DESCRIPTION
1	767	Cap Screw	5/16 - 24 x 1 1/2 Hex. Head
3	2239	Snap Ring	
4	1209-S	Clutch Shaft 25" and 70" Plain Machine - (Splined)	
	1156-S	Clutch Shaft 30" and 75" Plain Machine - (Splined)	
④	1640-S	Clutch Shaft 70" - Reverse Machine - Includes 1 - #1750 (Splined)	
	1641-S	Clutch Shaft 75" - Reverse Machine - Includes 1 - #1750 (Splined)	
5	757-X	Clutch Shaft Bracket - Plain Machine	
⑤	1523	Clutch Shaft Bracket L.H. - Reverse Machine.	
6	796	Fillister Head Screw	10 - 32 x 1
7	795-B	Bronze Clutch Cone Thrust Collar - Collar - Includes 2 - #796	
8	792	Clutch Dog Pin	
9	1091	Cutter Pin	1/16 x 3/8
10	1397	Clutch Cone	
11	785	Clutch Friction Disc - Moulded Fiber	3/32" Thick
12	1401	Clutch Pressure Plate Assembly 60 #	
	1401-X	Clutch Pressure Plate Assembly 70 #	
Note: Used with 19DR6 & 23AR6 Motors			
13	956-S	Iron Clutch Driving Plate with Driving Studs - (Splined)	
14	959	Clutch Friction Disc #2	1/8" Thick
15	776	Woodruff Key No. 606 (9) Heat Treated	
16	775	Clutch Sprocket Stud	
17	773	Flat Head Screw	10 - 32 x 5/8
18	955	Clutch Cover	
19	1217	Tractor Clutch Sprocket 10T, 14R6 and 8R6 Motor	1/2 x 1/4 x .335
20	777	Hex. Nut	1/2 x 20
21	2081	Clutch Shaft Ball Bearing Felt Retainer Cap - Plain Machine	
②①	1500	Clutch Shaft Ball Bearing Felt Retainer Cap - Reverse Machine	
22	2082	Clutch Shaft Ball Bearing Felt - Plain Machine	2 x 1 3/16 x 1/4
②②	1707	Clutch Shaft Felt Washer - Reverse Machine	1 3/16 x 1 15/16 x 1/4
23	2232	Clutch Shaft Ball Bearing Rubber Seal	
24	2148	Ball Bearing - Plain Machine (Sealed) Replaces 1109-0	
②④	1503	Ball Bearing Sealed - Reverse Machine	
26	2083	Clutch Shaft Ball Bearing Felt (Clutch Side)	1 15/16 x 1 1/4 x 1/4
27	2081	Clutch Shaft Ball Bearing Felt Retainer Cap - Plain Machine	
②⑦	1500	Clutch Shaft Ball Bearing Felt Retainer Cap - Reverse Machine	
28	1398	Clutch Dog	
29	2147	Clutch Housing Bushing - Bronze - Replaces 770 & 771	
30	1879	Hydraulic Fitting Alemite #A-1641 or Lincoln #5010	
31	1165	"V" Brake Clutch Housing	
33	784	Clutch Driving Plate Hardened Thrust Washer	
34	957	Clutch Driving Plate #2	
35	1164	Clutch Cover Ball Bearing	
36	785	Clutch Friction Disc - Moulded Fiber	3/32" Thick

NOTE: On Reverse Machines, Cutter Clutch Assembly is the same as above except parts numbered ④ ⑤ ②① ②② ②④ and ②⑦



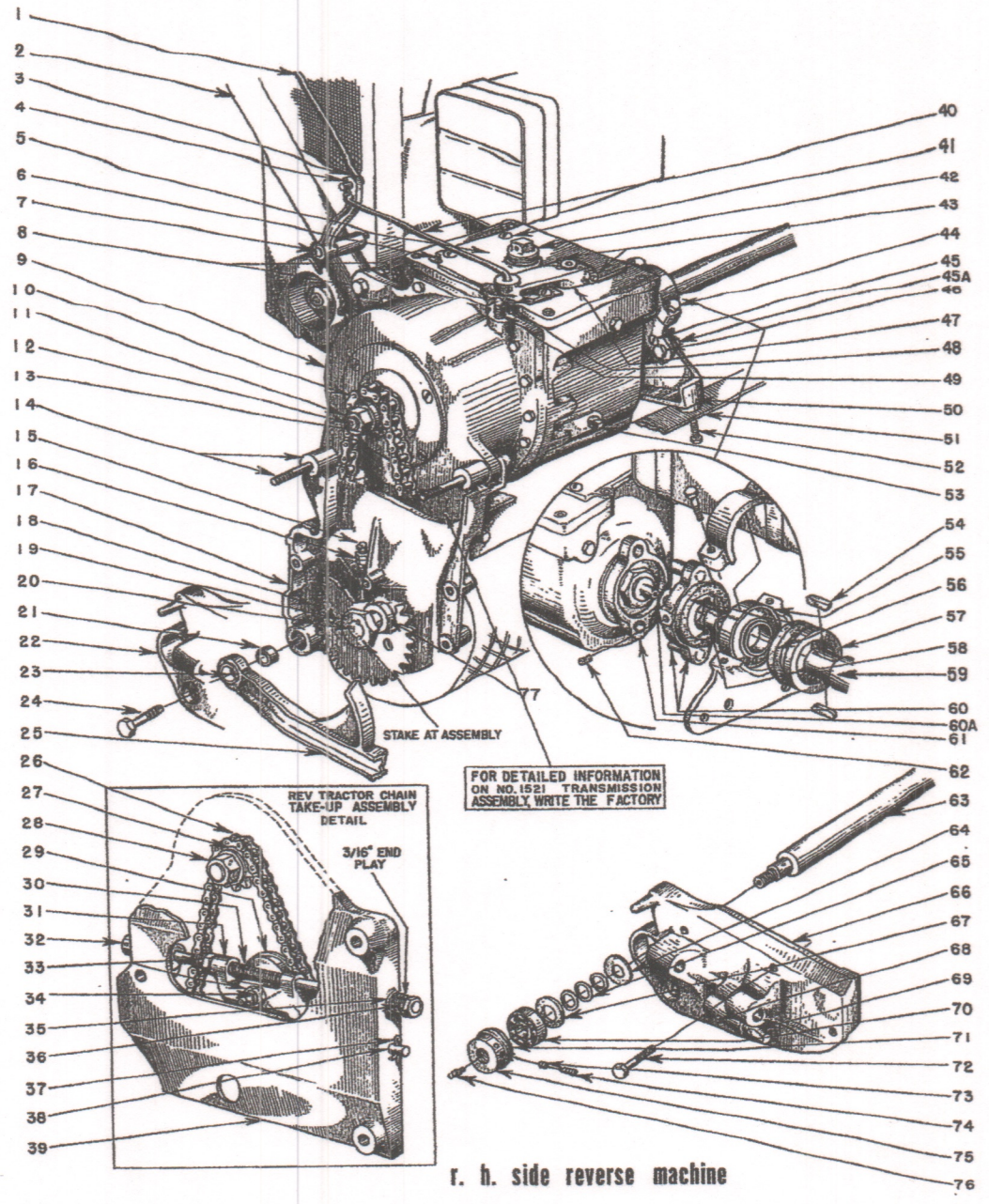

parts list number 5

KEY NO.	PART NO.	PART NAME	DESCRIPTION
1	1665	Tractor Clutch Rod - Reverse Machine	
2	2188	Handle Bar Assembly (With 1-705 and 1-1569 Brazed 1 - #733) 25" and 70" Reverse	
	2189	Handle Bar Assembly (With 1-705 and 1-1569 Brazed 1 - #733) 30" and 75" Reverse	
3	1570	Reverse Tractor Clutch Linkage Lever Includes 1 - #1570 1 - #1724-1 Groov Pin	
4	1893	Cotter Pin	3/32 x 1/2
5	1528-1	Reverse Gear Housing Cover Plate	
6	1739	Reverse Gear Housing Cover Gasket	
7	1724-1	Groov Pin Bronze - Drilled	3/8 x 2 1/2
8	708	Cap Screw	3/8 - 24 x 1 Hex. Head
	1735	Lock Nut	3/8 - 24 Flex Loc
9	1521	Reverse Gear Transmission Assembly Complete	
10	1746-W	Tractor Chain 32 1/2" Long	1/2 x 5/16 x .335 #515
11	1734	Lock Nut	5/8 - 18 R.H. Hex.
12	1562-1	Reverse Gear Tractor Sprocket Stud	
13	1563	Reverse Gear Tractor Sprocket 10T.	1/2 P. - .335 Roll
14	1853	Reverse Gear Transmission Mounting Stud	3/8 - 24 x 4 1/16
	1769	Tractor Chain Guard and Take-up Bracket Spacer - Reverse Machine	
15	1878	Hydraulic Fitting Alemite #A-1612 or Lincoln #5300	
16	1827	R.H. Tractor Side Plate Grease Fitting Hex. Extension - Reverse Machine	
17	1576-S	Tractor Side Plate R.H. - Reverse Machine Includes 1 - #1385, 1 - #1781, 1 - #1782, 1 - #1827	
18	1656-L	Tractor Roll Shaft Sprocket 32T. - Reverse Machine	1/2 x 1/4 x .335
19	2004	Lock Nut	7/8 - 14 L.H. Thread
20	1643	70" Triplex Tractor Shaft - Reverse Machine	
	1655	75" Triplex Tractor Shaft - Reverse Machine	
21	1690	Distance Link Hardened Plug - Reverse Machine	
22	1584	Side Unit Pivot Bracket - R.H. Assembly - Reverse Machine	Includes 1 - #1447
23	1689	Distance Link Bushing Bronze - Reverse Machine	
24	858	Bolt	3/8 - 24 x 1 3/4 Hex. Head
25	1586	Cutter Unit Distance Link R.H. - Reverse Machine Includes 1 - #1340 Bushing 1 - #1689 Bronze Bushing	
26	1746-W	Tractor Chain - Reverse Machine 32 1/2" Long	1/2 x 5/16 x .335 #515
27	1563	Reverse Gear Tractor Sprocket 10T.	1/2 P. - .335 Roll
28	1734	Lock Nut	5/8 - 18 R.H. Hex.
29	1600-A	Tractor Chain Idler Roll Assembly - Reverse Machine	
30	2127	Take-up Rod - Reverse Machine	7/16 - 20
31	1588-1	Chain Take-up Carrier - Reverse Machine	
32	1735	Lock Nut	3/8 - 24 Flex Loc
33	1184	Swinging Idler Hanger Stud Thin Nut	7/16 - 20
34	1603-1	Tractor Chain Idler Roll Stud - Reverse Machine	
35	2126	Chain Take-up Spring - Reverse Machine	
36	1184	Swinging Idler Hanger Stud Thin Nut	7/16 - 20
37	1896	Cotter Pin	1/8 x 3/4
38	1608	Tractor Chain Tightener Guide Rod - Reverse Machine	
39	1579-1	Tractor Chain Guard and Take-up Bracket	
40	1742	Tractor Clutch Linkage Rod - Reverse Machine	
41	1646	Round Head Screw	1/4 - 20 x 1/2



parts list number 5

KEY NO.	PART NO.	PART NAME	DESCRIPTION
42	1572-1	3/4" Pipe Plug Drilled	
43	767	Cap Screw	5/16 - 24 x 1 1/2 Hex. Head
	1861	Lock Nut	5/16 - 24
44	767	Cap Screw	5/16 - 24 x 1 1/2 Hex. Head
45	2064	Cutter Chain Guard Screw	1/4 - 28 x 1 Flat Head
	1370	Hex. Nut	3/4 - 28
45A	724J	Hex Nut	3/8 - 24 Jam
46	707	Cap Screw	3/8 - 24 x 3/4 Hex. Head
47	1530	Reverse Gear Clutch Shifting Lever	
48	1651	7/16" Steel Ball	
49	1535	Reverse Gear Clutch Lever Ball Check Spring	
50	1524-A	Clutch Shaft Bracket Assembly - Center - Reverse Machine	
		Includes 2 - #707 Cap Screw	5/16 - 24 x 1 1/2 Hex. Head
		2 - #707 Cap Screw	3/8 - 24 x 3/4 Hex. Head
		2 - #724d Hex. Nut	3/8 - 24 Jam
		2 - #1370 Hex. Nut	3/4 - 28
		1 - #2064 Cap Screw	1/4 - 28 x 1 Flat Head
		1 - #1778 Cap Screw	3/4 - 28 x 1 Hex. Head
51	1572	Tractor Cross Frame - 75" Front - Reverse Machine	
	1636	Tractor Cross Frame - 70" Front - Reverse Machine	
52	707	Cap Screw	3/8 - 24 x 3/4 Hex. Head
53	1723	Reverse Gear Housing Drain Plug	1/2" Pipe
54	1558	Reverse Gear Input Shaft Driving Dog Woodruff Key and Clutch Shaft Driver Woodruff Key	
55	1503	Clutch Shaft Ball Bearing Double Seal - Reverse Machine	
56	1707	Clutch Shaft Felt Washer - Reverse Machine	1 3/16 x 1 15/16 x 1/4
57	1500	Clutch Shaft Ball Bearing Felt Retainer Cup - Reverse Machine	
58	1750	Clutch Shaft Bushing - Reverse Machine	
59	1640-1	70" Triplex Clutch Shaft - Reverse Machine Includes 1 - #1750	
	1641-1	75" Triplex Clutch Shaft - Reverse Machine Includes 1 - #1750	
60	1642-1	Clutch Shaft Driver - Reverse Machine Includes 2 - #1750	
	1758	Input Driving Dog Stud - Reverse Machine	
60A	1779	Thrust Washer	7/16 x 15/16 x 1/16
61	1728	Reverse Gear Input Shaft Driver	
62	761	Set Screw	5/16 - 24 x 7/16 Cup Point
63	1638	70" Triplex Countershaft - Reverse Machine	
	1639	75" Triplex Countershaft - Reverse Machine	
64	1703	Countershaft R.H. Slinger Washer - Reverse Machine	5/8 5/4 x 1 35/64 x 1/16
65	2195	Ball Bearing Shim	2.16" Thick
66	1584	Side Unit Pivot Bracket R.H. Assembly - Reverse Machine	
		Includes 1 - #1447 Side Unit Pivot Bracket Stop Bar	
67	1705	Countershaft R.H. Felt Washer - Reverse Machine	1 x 1 3/16 x 3/16
68	1898	Cotter Pin	1/8 x 1 1/4
69	1447	Side Unit Pivot Bracket Stop Bar	
70	869	Ball Bearing - Single Felt Seal	
71	848	Felt	1 7/8 x 1 1/2 x 3/16
72	995	Cap Screw	3/8 - 24 x 2 Hex. Head
73	762	Set Screw Slug - Brass	
74	761	Set Screw	5/16 - 24 x 7/16 Cup Point
75	990	Nut L.H. Thread	
76	1879	Hydraulic Fitting Alemite #A-1641 or Lincoln #5210	
77	2207	Oil Seal	



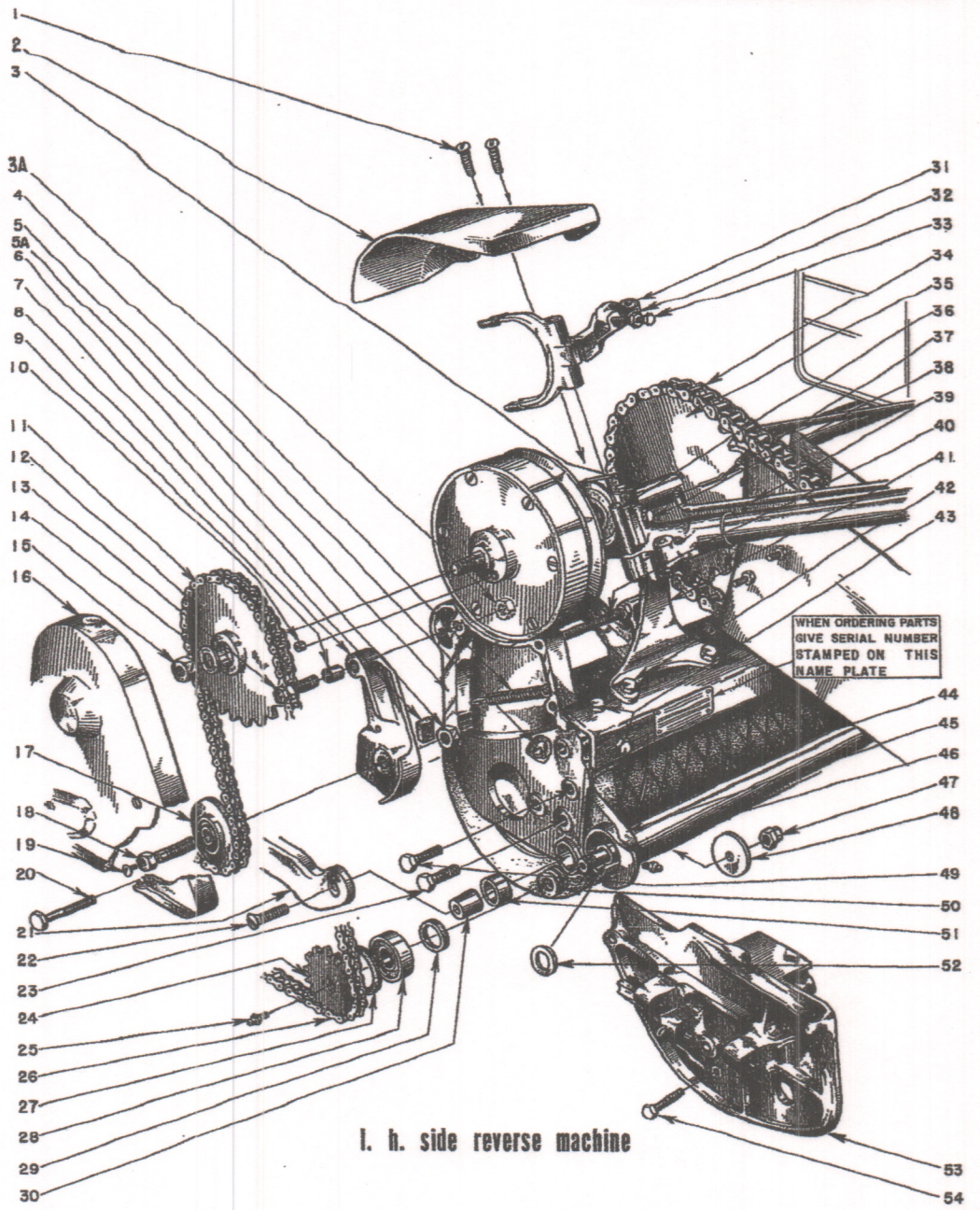

parts list number 6

KEY NO.	PART NO.	PART NAME	DESCRIPTION
1	1409	Screw	1/4 - 28 x 5/8 Round Head
2	1303	Clutch Guard L.H.	
3	1640-1	75" Triplex Clutch Shaft - Reverse Machine	
	1641-1	Includes 1 - #1750 Clutch Shaft Bushing	
		75" Triplex Clutch Shaft - Reverse Machine	
		Includes 1 - #1750 Clutch Shaft Bushing	
3A	777	Hex. Nut	1/2 - 20
4	812	Tension Spring	5/8 x 3 1/2
5	1878	Hydraulic Fitting Alemite #A-1612 or Lincoln #5300	
5A	1577-5	Tractor Side Frame	
6	777	Hex. Nut	1/2 - 20
7	924-1	Cutter Chain Swinging Idler Hanger Bumper	
8	1592	Swinging Idler Hanger - Reverse Machine	
		includes 1 - #1622	
		1 - #924-1	
7	1022	Swinging Idler Hanger Bushing - Bronze	
10	781	Clutch Sprocket Key	
11	1744	Cutter Chain - Reverse Mowers	1/2 x 1/4 x .335 - 63 1/2" Long #514
	1258	Cutter Chain - 25" Heavy Duty and 30" Mowers	1/2 x 1/4 x .335 - 60 1/2" Long #514
	1263	Cutter Chain - Plain Triplex Mowers	1/2 x 1/4 x .335 - 64" Long #514
12	1237	Cutter Clutch Sprocket 28T. - Reverse Machine	1/2 P - .335 Roll
13	1730	Swinging Idler Stud - Reverse Machine	
14	778	Washer	1 1/8 x 33/64 x 1/8
15	777	Hex. Nut	1/2 - 20
16	1589	Cutter Chain Guard - Reverse Machine	
17	1059	Cutter Chain Idler Roll Assembly	
18	805	Idler Roll Stud (Swinging)	
19	1186	Screw	1/4 - 28 x 1/4" Long - Round Head
20	858	Cap Screw	3/8 - 24 x 1 3/4 Hex. Head
21	1587	Cutter Unit Distance Link L.H. - Reverse Machine	
		includes 1 - #1340B Bushing	
22	1688	L.H. Distance Link Flar Head Screw - Reverse Machine	3/8 - 24 x 1 1/2
23	1732	Cap Screw	1/2 - 20 x 1 Hex. Head
24	970	Triplex Counter Shaft End Sprocket 20T.	1/2 P - .335 Roll
25	1879	Hydraulic Fitting Alemite #A-1641 or Lincoln #5010	
26	1744	Cutter Chain - Reverse Machine	1/2 x 1/4 x .335 - 63 1/2" Long #514
27	1706	Countershaft Sprocket Felt Washer - Reverse Mach.	1 1/2 x 2 1/16 x 3/16
28	1766-1	Ball Bearing (Single Seal & Single Shield)	
29	1704	Countershaft L.H. Felt Washer - Reverse Machine	1 7/32 x 1 3/4 x 3/16
30	1690	Distance Link Hardened Plug	
31	1210-R	Clutch Fork, Malleable Iron - Reverse Machine	
32	744	Hex. Nut	5/16 - 24
33	767	Cap Screw	5/16 - 24 x 1 1/2 Hex. Head
34	1593	Motor Chain 14R6 & 19R6 Motor	3/4 x 1/2 x 15/32 - 38 1/4 Long #60
35	1236	Clutch Shaft Sprocket 25T.	3/4 x 1/2 x 15/32 (1 3/16 Bore)
36	733	Groov Pin	1/2 x 3 1/4
37	1892	Cotter Pin	1/16 x 1/2
38	707	Cap Screw	3/8 - 24 x 1 Hex. Head
39	1666	Cutter Clutch Rod - Reverse Machine	
40	1007	Tie Bolt	3/8 - 24 x 5 1/8
	724-J	Hex. Nut	3/8 - 24 Jam
41	1523	Clutch Shaft Bracket L.H. - Reverse Machine	
42	708	Cap Screw	3/8 - 24 x 1 Hex. Head
43	707	Cap Screw	3/8 - 24 x 3/4 Hex. Head
44	1070-X3	Tractor Roll Assembly (Rubber) Includes 1 - #242, 1 - #1381	
45	1597	Countershaft Bracket L.H. - Reverse Machine	
46	1638	70" Triplex Countershaft - Reverse Machine	
	1639	75" Triplex Countershaft - Reverse Machine	
47	1735	L.H. Distance Link Lock Nut - Flex Loc	3/8 - 24
48	1691	L.H. Distance Link Washer - Reverse Machine	13/32 x 1 1/2 x 3/32
49	708	Cap Screw	3/8 - 24 x 1 Hex. Head
50	1702	Countershaft L.H. Shim Washer - Reverse Machine	1 1/32 x 1 15/64 x 1/16
51	1689	Distance Link Bushing Bronze - Reverse Machine	
52	1701	L.H. Countershaft Slinger Washer - Reverse Machine	1 1/32 x 1 47/64 x 1/16
53	1585	Side Unit Pivot Bracket L.H. Assembly - Reverse Machine	
		Includes 1 - #1447	
54	2107	Cap Screw - 3 used on #1585	3/8 - 24 x 2 1/2 Hex. Head
	1764	Not illustrated between Key No. 27 and 28 on Parts Plate	
		L.H. Countershaft Gland Washer	.753 x 1 3/8 x 1/16



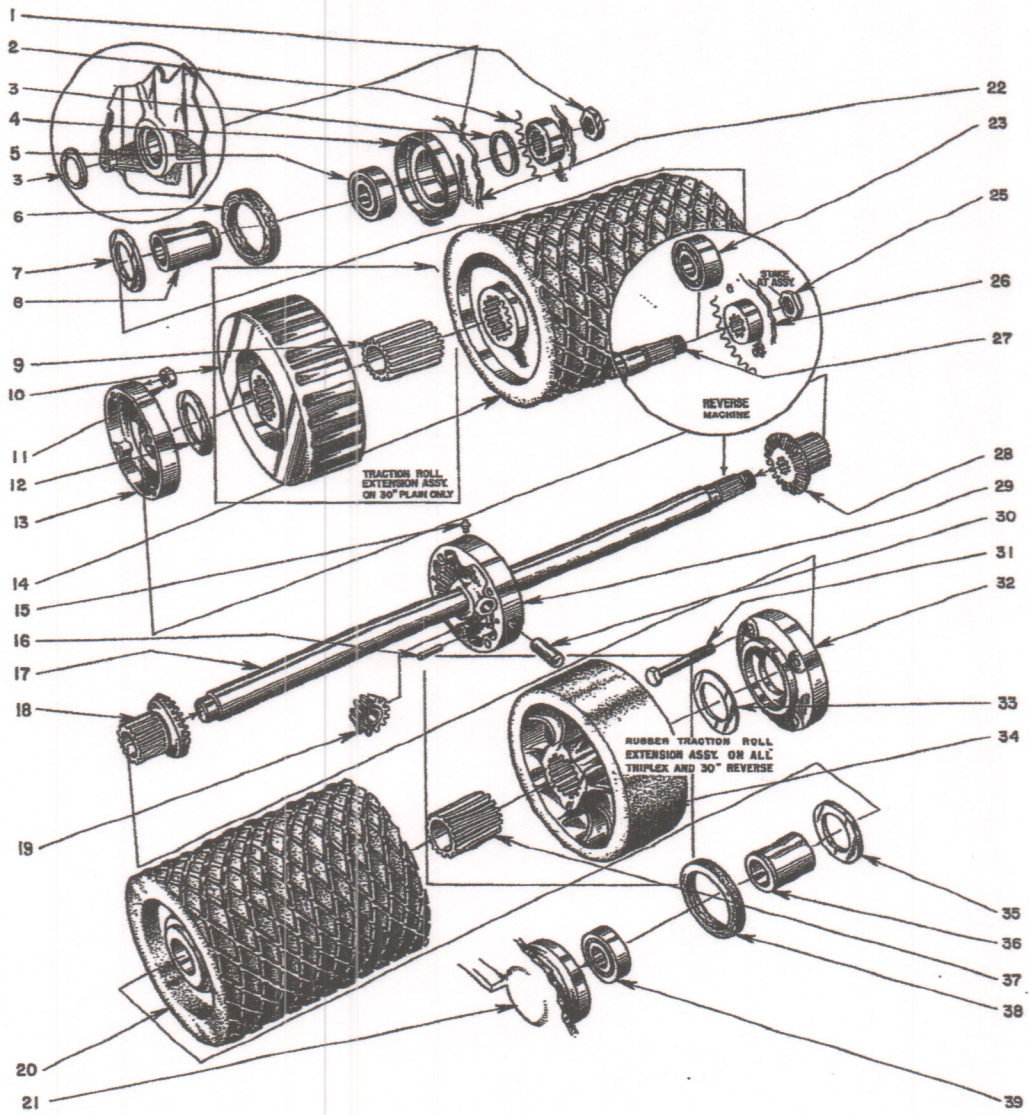

traction unit

parts list number 7

KEY NO.	PART NO.	PART NAME	DESCRIPTION
1	2004-S	Tractor Roll Shaft Lock Nut	3/4 - 16 R.H. Thread
2	1656-S	Tractor Roll Shaft Sprocket (32T) Splined	1/2 x 1/4 x .335
3	2207	Garlock Seal	
4	1385	Tractor Roll Shaft Bearing Guard Ring	
5	1109-0	Ball Bearing (No Shield) Plain Machine	1 x 2 x 5/8
6	1781-1	Tractor Roll Shaft Guard Ring - Inner Felt Washer	2 11/16 x 3 1/4 x 9/16
7	1381	Hardened Thrust Washer	1 1/2 - 2 11/16 x 1/8
8	842	Tractor Roll Bronze Bushing	
9	1505-S	Tractor Roll Extension Sleeve (Splined)	
10	1383-S	Tractor Roll Extension Assembly (For 30") Iron (Splined)	
		Includes 1 - #1505-S	
11	724	Hex. Nut	3/8 - 24
12	1378	Shim Washer	1 7/8 x 2 11/16 x 1/8
	1379	Shim Washer	1 7/8 x 2 11/16 x 3/32
	1380	Shim Washer	1 7/8 x 2 11/16 x 5/32
13	854	Differential Side Plate	
14	1070-S	Tractor Roll Assembly (Rubber) Splined	
		Includes 1 - #842	
		1 - #1381	
15	1879	Hydraulic Fitting Alemite #A-1641 or Lincoln #5010	
16	706	Groov-Pin	3/16 x 1 1/2
17	844-S	Tractor Roll Shaft 25° and 70° Plain Machine Splined	
	1155-S	Tractor Roll Shaft 30° and 75° Plain Machine Splined	
18	849-SP	Differential Bevel Gear (Splined)	
19	850	Differential Bevel Pinion	
20	1070-S	Tractor Roll Assembly (Rubber) Splined	
		Includes 1 - #842	
		1 - #1381	
21	963-S	Tractor Side Plate L.H., Plain Machine Triplex	
		Includes 1 - #1385	
		1 - #1781-1	
		1 - #817	
	798-S	Tractor Side Plate L.H. Single Unit	
		Includes 1 - #1385	
		1 - #1781-1	
		1 - #817	



parts list number 7

KEY NO.	PART NO.	PART NAME	DESCRIPTION
21	1577-S	Tractor Side Plate L.H. - Reverse Machine	
		Includes 1 - #1385	
		1 - #1781-1	
		1 - #1689	
22	797-S	Tractor Side Plate R.B. Single Unit	
		Includes 1 - #1385	
		1 - #1781-1	
	962-S	Tractor Side Plate R.H. Plain Machine Triplex	
		Includes 1 - #1385	
		1 - #1781-1	
	1576-S	Tractor Side Plate R.H. - Reverse Machine	
		Includes 1 - #1385	
		1 - #1781-1	
		1 - #1827	
23	2206	Ball Bearing Single - Reverse Machine No Seal	
25	2004-S	Tractor Roll Shaft Lock Nut	3/4 - 16 Jam Nut
26	1656-S	Tractor Roll Shaft Sprocket 32T. - Reverse Machine	1 2 x 1/4 x .335
27	1643-S	70° Triplex Tractor Shaft - Reverse Machine Splined	
	1655-S	75° Triplex Tractor Shaft - Reverse Machine Splined	
28	849-SP	Differential Bevel Gear - Splined	
29	853-I	Differential Center Plate - Iron	
	768	Woodruff Key No. 807 (A) - Heat Treated (Not Shown)	
30	851	Differential Bevel Pinion Stud	
31	855	Cap Screw	3 8 - 24 x 2 3/4 Hex. Head
32	854	Differential Side Plate	
33	1378	Washer	1 7/8 x 2 11/16 x 1/8
	1379	Washer	1 7/8 x 2 11/16 x 3/32
	1380	Washer	1 7/8 x 2 11/16 x 5/32
34	1520-S	Tractor Roll Extension Assembly - (Rubbered Covered) Splined	
		Includes 1 - #1505-S	
35	1381	Washer	1 1/2 x 2 11/16 x 1/8
36	842	Tractor Roll Bushing Flanged	1 1/2 x 1 1/4 x 1 13/16
37	1505-S	Tractor Roll Extension Sleeve (Splined)	
38	1781-1	Tractor Roll Shaft Guard Ring - Inner Felt Washer	2 11/16 x 3 1/4 x 9/16
39	1109-0	Ball Bearing, Plain Machine (No Shield)	
	2206	Ball Bearing - Reverse Machine	



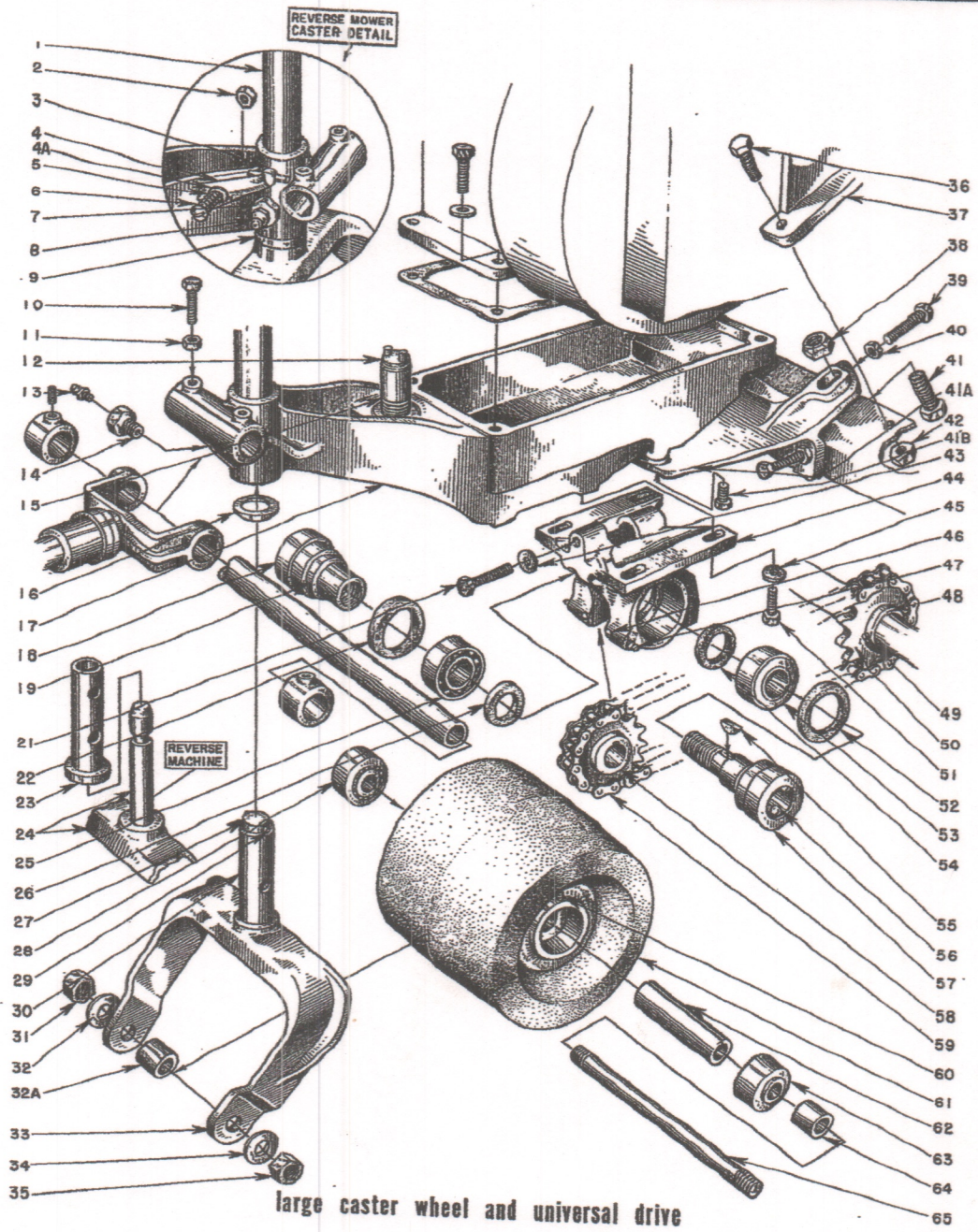

parts list number 8

KEY NO.	PART NO.	PART NAME	QTY
1	2188	Handle Bar Assembly 70° - Reverse Machine (With 1-705 and 1-1569 Brazed)	
	2189	Handle Bar Assembly 75° - Reverse Machine (With 1-705 and 1-1569 Brazed)	
2	1370-1	Hex. Nut	4 - 20
3	1717	Caster Post Release Pin Assembly Includes 1 - #703L Groov-Pin No. 7	1 - 703L Groov-Pin No. 7
4	1718	Caster Post Release Lever - Reverse Machine	
4A	2149	1/4" Steel Burr	
5	1719	Caster Post Release Spring - Reverse Machine	
6	1369-1	Caster Post Release Lever Screw	4 - 20 x 1 3/4 Round Head
7	835-1	Caster Post Bushing Dowel	
8	1879	Hydraulic Fitting Alemite #A-1641 or Lincoln #5010	
9	1716	Caster Post Bushing - Reverse Machine	
10	767	Cap Screw	10 - 16 - 24 x 1 1/2 Hex. Head
11	744	Hex. Nut	10 - 16 - 24 x 1 1/2 Hex. Head
12	2177	Oil Filler Cap - Nylon - Briggs and Stratton #20768	
13	1877	Hydraulic Fitting Alemite #A-1641 or Lincoln #5010	
14	836-1	Caster Post Bushing Dowel	
15	2176	Oil Filler Pipe - For Motor Base - For B & S #22547	
16	1625	Caster Post Bushing Thrust Washer (Hardened)	1 - 2 x 1 3/4 x 1 1/8
17	1506	Motor Base 14R6 Motor & 19R6	
	1506-23	Motor Base 23AR6 Motor	
18	992-1	Ball Retainer Cup (Universal Joint)	
19	1013	Universal Drive Socket L.H. Assembly Includes 1 - #1013, 3 - #991, 1 - #992-1	
21	767	Cap Screw	5 - 16 - 24 x 1 1/2 Hex. Head
22	846	Felt Washer	1 x 1 1/2 x 3/16
23	1716	Caster Post Bushing - Reverse Machine	
24	979-XR	Caster Fork Assembly - Reverse Machine Includes 1 - #1729	
	1729	Caster Post - Reverse Machine	
25	1109	Ball Bearing (Shield on One Side)	
26	966	Felt Washer	1 - 3/8 x 1 x 3/16
27	977	Caster Post - Plain Machine	
28	1071	Caster Wheel Ball Bearing	
29	716	Caster Post Groov-Pin No. 5	3 - 76 x 1
30	978	Caster Post Bushing - Plain Machine	
31	777	Hex. Nut	1 - 2 - 20
32	778	Washer	1 - 1/8 x 33/64 x 1/8
32A	831-X	Caster Wheel Spacer	5/8 Wide
33	979-X	Caster Fork Assembly - Plain Machine Includes 1 - #977 Caster Post	
34	778	Washer	1 - 1/8 x 33/64 x 1/8
35	777	Hex. Nut	1 - 2 - 20
36	708	Cap Screw	3/8 - 24 x 1 Hex. Head
37	1633	Motor Chain Guard Bracket - All Models Except 70° Reverse	
	1633-1	Motor Chain Guard Bracket - 70° Reverse Only	
38	1780	Motor Adjusting Bracket Lock Nut	1/2 - 20 Flex Lok
39	767	Cap Screw	5/16 - 24 x 1 1/2 Hex. Head
40	744	Hex. Nut	5/16 - 24
41	1056	Bolt	1/2 - 20 x 1 1/4
41A	1402	Motor Base Bracket	
41B	708-1	Bolt	3/8 - 16 x 1
42	1735	Lock Nut	3/8 - 24 Nylok
43	923	Washer	3/4 x 11/32 x 1/16
44	1011-H	Universal Drive Bracket (For High Cut 1 1/4" or Higher)	
	1011	Universal Drive Bracket (For Low Cut up to 1 1/4")	
45	923	Washer	3/4 x 11/32 x 1/16
46	1350-2	Machine Screw	10 - 32 x 3/16 Round Head
47	1879	Hydraulic Fitting Alemite #A-1641 or Lincoln #5010	
48	768	Woodruff Key No. 807 (A) Heat Treated	
49	706	Groov-Pin	3/16 x 1 1/2
50	1225	Countershaft Center Sprocket 20T.	1/2 x 1/4 x .335 (1 3/16 Bore)
51	746-1	Cap Screw	5/16 - 18 x 1 Hex. Head
52	846	Felt Washer	2 x 1 1/2 x 3/16
53	1109	Ball Bearing (Shield on One Side)	
54	966	Felt Washer	1 3/8 x 1 x 3/16
55	776	Woodruff Key No. 606 (9) Heat Treated	
56	1012	Universal Drive Socket and Sprocket Shaft R.H. Assembly Includes 1 - #1012, 3 - #991, 1 - #992-1	
	991	1/2" Steel Ball (Universal Joint)	
57	992-1	Ball Retainer Cup (Universal Joint)	1 15/16 I.D.
58	1227	Universal Shaft Sprocket 17T.	1/2 x 1/4 x .335 (3/4 Bore)
59	1264	Universal Chain 23" Long	1/2 x 1/4 x .335 #514
	1264-1	Universal Chain 22 1/2" Long used in C Triplex Mower	
60	1878	Hydraulic Fitting Alemite #A-1612 or Lincoln #5300	
61	1244-X	Caster Wheel Assembly - 6" Rubber Face	
62	830	Caster Wheel Ball Bearing Spacer (Inner)	3/4 O.D. .505 to .515 I.D. 2 3/8" Long
63	1071	Caster Wheel Ball Bearing	
64	831-X	Caster Wheel Spacer	5/8 W de
65	975-X	Caster Wheel Spindle	1 1/2" Lc-g



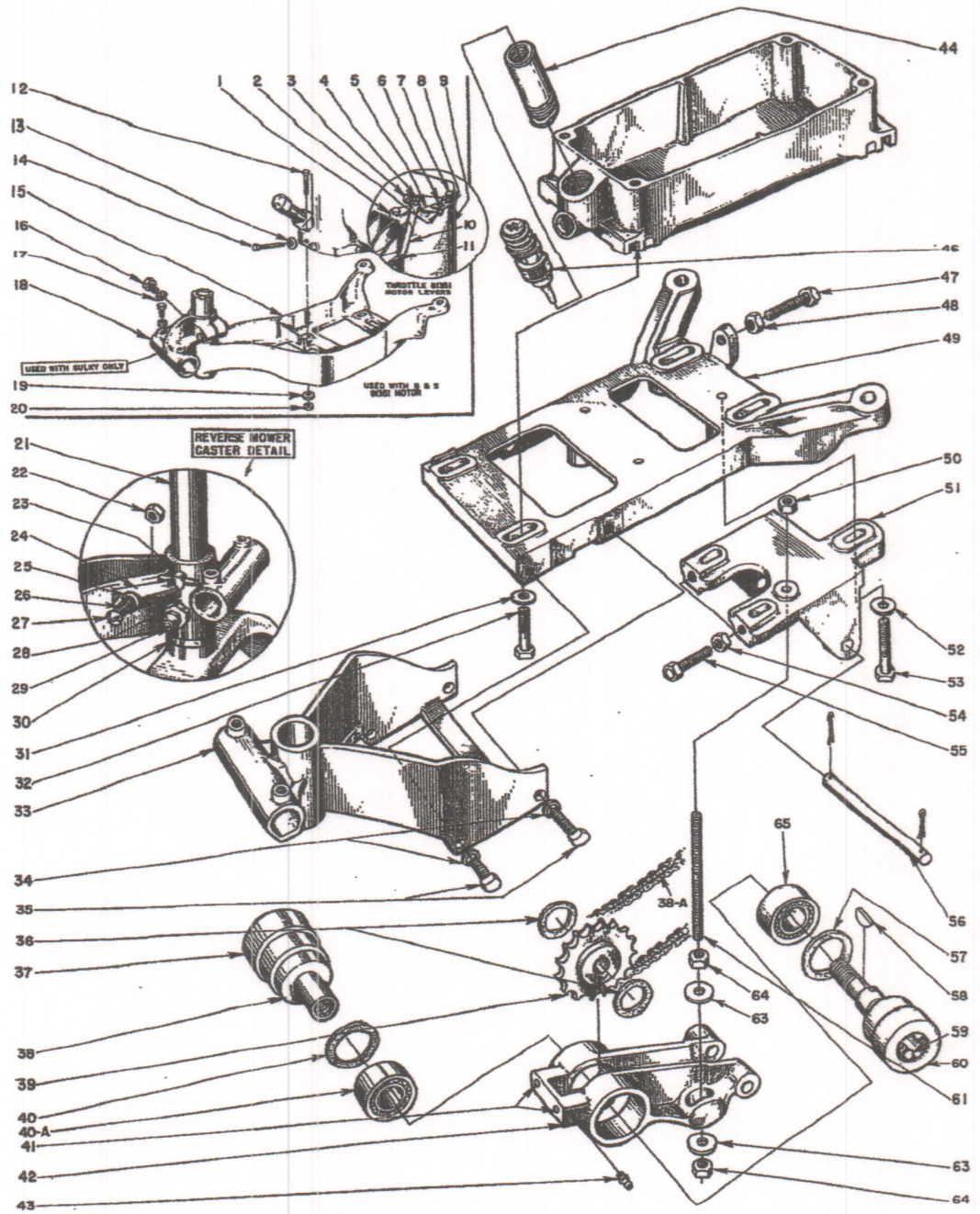

parts list number 9

KEY NO.	PART NO.	PART NAME	DESCRIPTION
1	2125	Speed Control Bell Crank Bracket	
2	1370	Hex Nut	1/4-28
3	1370	Hex Nut	1/4-28
4	1409	Screw	1/4-28 x 5/8 Round Head
5	2122	Governor Arm (B. & S. 220246)	
6	1409	Screw	1/4-28 x 5/8 Round Head
7	2123	Adjusting Nut (B. & S. 230149)	
8	2124	Spring (B. & S. 26855)	
9	2129	Governor Rod (B. & S. 230419)	
10	1857	Motor Bell Crank	
11	1859	Speed Control Linkage Rod	
12	1628	Cap Screw	5/16-24 x 1 3/4 Hex Head
13	923	Washer	3/4-11/32 x 1/16
14	2164	Cap Screw	5/16-18 x 1 1/2 Hex Head
15	1578-1	Motor Base, 81351 Motor	
16	836-1	Dowel	
17	2242	Washer Shakeproof - Use under head of Dowel 836-1 on 1578-1, Base Only (Not Illustrated)	
18	1114	Sulky Hitch - Item 2 Only	
19	923	Washer	3/4-11/32 x 1/16
20	744	Hex Nut	5/16-24
21	2188	Handle Bar Assembly 70° - Reverse Machine	
22	2189	Handle Bar Assembly 75° - Reverse Machine	
23	1370-1	Hex Nut	1/4-20
24	1717	Caster Post Release Pin Assembly - Includes 1-#703L	
25	1718	Caster Post Release Lever - Reverse Machine	
26	2149	1/4" Steel Burr	
27	1719	Caster Post Release Spring - Reverse Machine	
28	1369-1	Caster Post Release Lever Screw	1/4-20 x 1 3/4 Round Head
29	836-1	Caster Post Bushing Dowel	
30	1879	Hydraulic Fitting Alemite #A-1641 or Lincoln #5010	
31	1716	Caster Post Bushing - Reverse Machine	
32	923	Washer - Steel	11/32 x 3/4 x 1/16
33	2165	Cap Screw	3/8-16 x 1 3/4 Hex. Head
34	2244	Motor Base Handlebar Support	
35	2166	Lock Washer	3/8
36	708-1	Cap Screw	3/8-16 x 1 Hex. Head
37	966	Felt Washer	1 3/8 x 1 x 3/16
38	992-1	Ball Retainer Cup (Universal Joint)	
38A	1013	Universal Drive Socket L.H. Assembly Includes 1-#1013, 3-#991, 1-#992-1	
39	1264-1	Universal Chain	1/2 x 1/4 x .335 x 22 1/2
40	1227	Universal Shaft Sprocket 17T	1/2 x 1/4 x .335 (3/4 Bore)
41	846	Felt Washer	2 x 1 1/2 x 3/16
42	1109	Ball Bearing (Shield on One Side)	10-32 x 3/16 Round Head
43	1350-2	Machine Screw	
44	2168	Universal Sprocket Carrier	
45	1879	Hydraulic Fitting	
46	2176	Oil Filler Pipe	
47	2250	Oil Minder Assembly with 19DR6 Engine - Blue Tip (Not Shown)	
48	2251	Oil Minder Assembly with 23AR6 Engine - Red Tip (Shown)	
49	767	Cap Screw	5/16-24 x 1 1/2 Hex. Head
50	744	Hex. Nut	5/16-24
51	2245	Platform for 19DR6 Engine	
52	2246	Platform for 23AR6 Engine	
53	724J	Jam Nut	3/8-24
54	2167	Universal Bracket Base	
55	923	Washer - Steel	11/32 x 3/4 x 1/16
56	2170	Cap Screw	5/16-24 x 1 1/4 Hex. Head
57	744	Hex. Nut	5/16-24
58	767	Cap Screw	5/16-24 x 1 1/2 Hex. Head
59	2169	Universal Bracket Hinge Pin - Bronze	
60	846	Felt Washer	2 x 1 1/2 x 3/16
61	776	Woodruff Key No. 606 (9) Heat Treated	
62	1012	Universal Drive Socket and Sprocket Shaft R.H. Assembly Includes 1-#1012, 3-#991, 1-#992-1	
63	991	1/2" Steel Ball (Universal Joint)	
64	992-1	Ball Retainer Cup (Universal Joint)	1 15/16 I.D.
65	1007-S	Tie Bolt	
66	923	Washer - Steel	11/32 x 3/4 x 1/16
67	724J	Jam Nut	3/8-24
68	1109	Ball Bearing (Shield on One Side)	



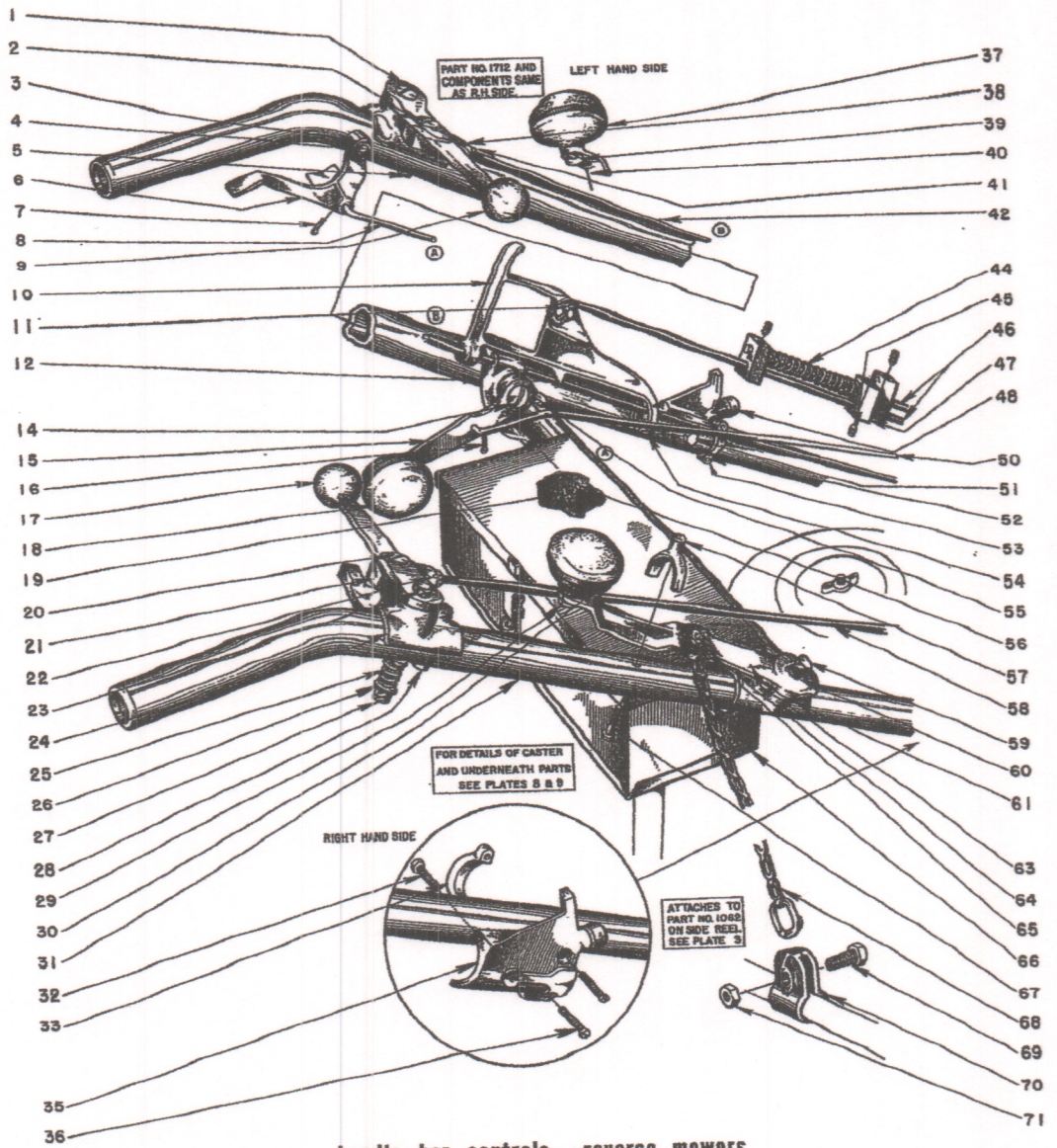

handle bar controls reverse mowers

parts list number 10

KEY NO.	PART NO.	PART NAME	DESCRIPTION
1	711	Clutch Control Hand Lever Fulcrum Stud	
2	711	Clutch Control Hand Lever Fulcrum Stud	
3	2149	1/4" Steel Burr #991	
4	2136	Speed Control Handle Rivet	
5	1628	Cap Screw	5/16 - 24 x 1 3/4 Hex. Head
6	1345-2	Speed Control Hand Lever	
7	1892	Cotter Pin	1/16 x 1/2
8	1613	Speed Control Rod for 14R6 Motor	
9	1620	Cutter Clutch Control Lever	
10	1753	Brake Lever Handle - Reverse Machine	
11	1893	Cotter Pin	3/32 x 1/2
12	1752	Clutch Rod Guide and Elevating Lever Bracket - Reverse Machine	
14	711	Clutch Control Hand Lever Fulcrum Stud	
15	1751-1	Front Cutting Unit Elevating Lever - Reverse Machine	
16	1893	Cotter Pin	3/32 x 1/2
17	1826	Tractor Clutch Control Lever	
18	1774-1	Lifting Lever Ball Screw	3/8 - 24 x 5/8 Oval Head
19	1369-1	Machine Screw	1/4 - 20 x 1 3/4 Round Head
20	711	Clutch Control Hand Lever Fulcrum Stud	
21	1626	Clutch Control Rod Ends	
22	724-J	Jam Nut	3/8 - 24 Hex.
23	1645	Cap Screw	3/8 - 24 x 3 1/2 Hex. Head
24	1819	Tractor Clutch Control Mounting Bracket	
25	787	Coil Spring (60#)	5/8 x 7/8
26	1595	Steel Washer	25/64 x 13/16 x 1/16
27	724-J	Jam Nut	3/8 - 24 Hex.
28	1628	Cap Screw	5/16 - 24 x 1 3/4 Hex. Head
29	707	Cap Screw	3/8 - 24 x 3/4 Hex. Head
30	1715	Lifting Lever Ball	
31	2188	Handle Bar Assembly	
32	767	Cap Screw	5/16 - 24 x 1 1/2 Hex. Head
33	948	Handle Bar Clamp	
35	946	Handle Bar Elevating Cutter Saddle	
36	796	Screw	10 - 32 x 1 Fillister Head
37	1715	Side Unit Lifting Lever Ball	
38	1626	Clutch Control Rod Ends	
39	707	Cap Screw	3/8 - 24 x 3/4 Hex. Head
40	1712	Side Unit Lifting Lever	
41	724-J	Jam Nut	3/8 - 24 Hex.
42	1666	Cutter Clutch Rod	
44	1671	Brake Rod Spring	
45	761	Set Screw - Socket Head	5/16 - 24 x 7/16 Cup Point
46	1752	Brake Rod	
47	1670	Brake Rod Runner	
48	947	Handle Bar Elevating Cutter Saddle	
49	2188	Handle Bar Assembly 70" Reverse (With 1-705 and 1-1569 Brazed)	
49	2189	Handle Bar Assembly 75" Reverse (With 1-705 and 1-1569 Brazed)	
50	1761	Front Cutting Unit Elevating Rod	
51	767	Cap Screw	5/16 - 24 x 1 1/2 Hex. Head
52	796	Screw	10 - 32 x 1 Fillister Head
53	948	Handle Bar Clamp	
54	1893	Cotter Pin	3/32 x 1/2
55	1628	Cap Screw	5/16 - 24 x 1 3/4 Hex. Head
56	2204	Hex. Nut	1/4 - 20 Tensilock
57	1773	Handle Bar Stud for Side Unit Lifting Lever	
58	1665	Tractor Clutch Rod	
59	708	Cap Screw	3/8 - 24 x 1 Hex. Head
60	729	Spring	9/16 x 3/8
61	1671	Side Unit Lifting Lever Mounting Bracket	
63	1712	Side Unit Lifting Lever	
64	1409	Screw	1/4 - 28 x 5/8 Round Head
65	1370	Hex. Nut	1/4 - 28
66	752	Tool Box	
67	1628	Cap Screw	5/16 - 24 x 1 3/4 Hex. Head
68	1692-3	Side Unit Lifting Chain Assembly Includes 1 - #1692, 1 - #1693	
69	858	Cap Screw	3/8 - 24 x 1 3/4 Hex. Head
70	1062	Side Unit Carrying Hook Pivot Clamp	
71	724-J	Jam Nut	3/8 - 24 Hex.



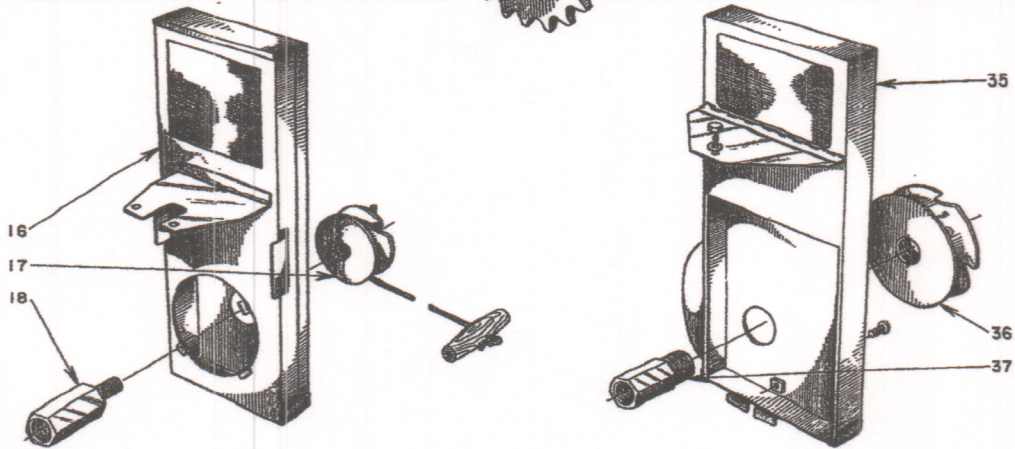
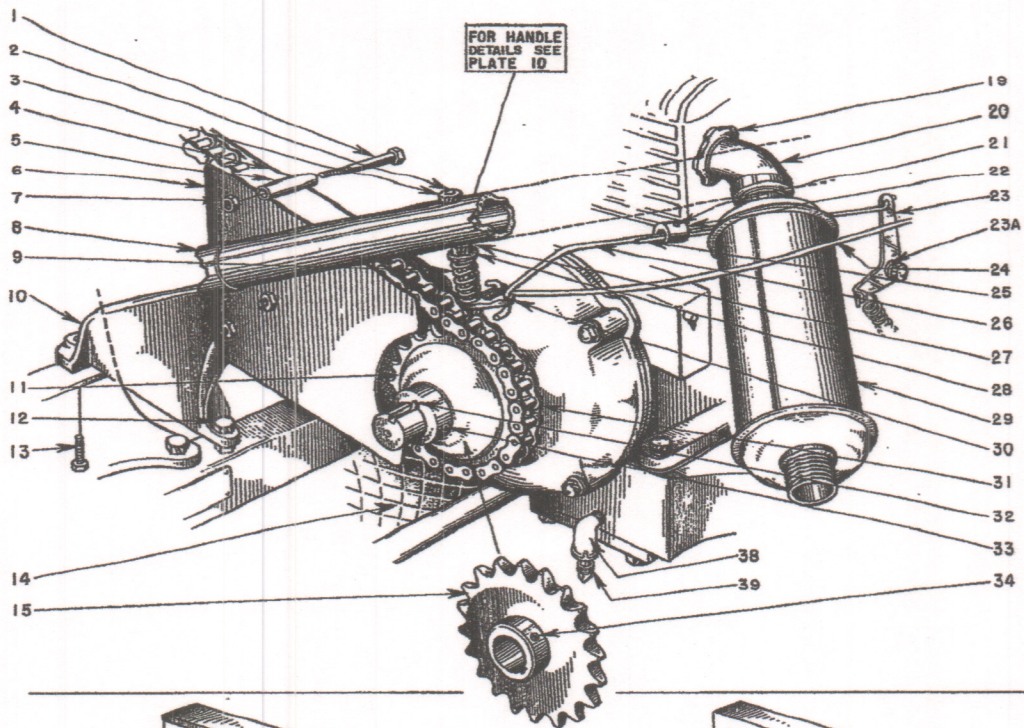

motor accessories

parts list number 11

KEY NO.	PART NO.	PART NAME	DESCRIPTION
1	1749	Cap Screw	1/4 - 20 x 2 1/2
	1748	Cap Screw	1/4 - 20 x 2
2	1654	Bolt	5/16 - 24 x 2 3/4 Hex. Head
3	744	Hex. Nut	5/16 - 24
4	1726	Motor Chain Guard - 70" and 75" Inner	
	1747	Motor Chain Guard	
5	1699	Motor Chain Guard Spacer	
	1700	Motor Chain Guard Spacer	
6	1725	Motor Chain Guard - 70" Outer	
	1727	Motor Chain Guard - 75" Outer	
7	1370-1	Hex. Nut	1/4 - 20
8	2186	Handle Bar 25" Assembly with Feet #704 and #705 Brazed	
	2167	Handle Bar 30" Assembly with #704 and #705 Brazed	
9	787	Spring	5/8 x 7/8 (60#)
10	1633-1	Motor Chain Guard Bracket	
	1633	Motor Chain Guard Bracket - 70" Reverse Only	
11	1507	Motor Sprocket 20T. Offset-14R6 Motor	3/4 P. - 1" Bore
	1759	Motor Sprocket 24T. Offset-14R6 Motor	3/4 x 1/2 x 15/32 1" Bore
	1760	Motor Sprocket 26T. Offset-14R6 Motor	3/4 x 1/2 x 15/32 1" Bore
12	708	Cap Screw	3/8 - 24 x 1 Hex. Head
	724	Hex. Nut	3/8 - 24
13	707	Cap Screw	3/8 - 24 x 3/4 Hex. Head
14	1070-X3	Tractor Roll Assembly (Rubber) Includes 1 - #842, 1 - #1381	
15	1205	Motor Sprocket 17T. 8R6 and 8BR6 Motor	5/8 - 3/8 x .400 (.750 Bore)
	2029	Motor Sprocket 20T. 14R6 Motor	3/4 - 1/2 x 15/32 - 1" Bore
	1228	Motor Sprocket 20T. 8R6 and 8BR6 Motor	5/8 - 3/8 x .400 (3/4" Bore)
	2161	Motor Sprocket 24 T.	3/4 - 12 x 15/32 - 1" Bore
16	2120	Screened Blower Intake Stack for 81351 Motor	
17	1838	Starter Pulley - 8R6 and 6R6 Motor	
18	1839-1	Starter Pulley Hex. Extension R.H. Thread	
19	1046	1" Conduit Lock Nut (Exhaust Pipe Lock)	
20	1499	1" Street Elbow 45°	
21	1350-1	Set Screw	1/4 - 28 x 1/4 Cup Point
22	1607	Speed Control Rod Adjusting Collar	
23	1606	Speed Control Bell Crank - Governor	
23A	1888	Shoulder Bushing for Bell Crank (B & S #23849)	
24	1613	Speed Control Rod 30" Long for 14R6 Motor	
25	1624	Speed Control Rod to Governor - 14R6 Motors	
26	1614	Speed Control Rod to Bell Crank	
		Speed Control Rod to Bell Crank for 25" and 70" Mowers	
27	744	Hex. Nut	5/16 - 24
28	923	Washer	11/32 x 3/4 x 1/16
29	1498	Nelson Type Muffler	
30	1605	Speed Control Bell Crank - Handle Bar	
31	1593	Motor Chain - 14R6 & 19R6 Motor	3/4 P. #60 - 51 P. 38 1/4" Long
	2133-1	Motor Chain 23R6 Item 23	3/4 P. #60 - 54 P. 40 1/2" Long
32	1772	Motor Sprocket Key - 14R6, 19R6 and 23R6 Motor	1/4 - 1/4 x 3/4
	1771	Motor Sprocket Key - 8R6 and 19R6 Motors	3/16 - 3/16 x 13/16
33	761	Set Screw	5/16 - 24 x 7/16 Cup Point
34	761	Set Screw	5/16 - 24 x 7/16 Cup Point
35	1511	Blower Intake Stack - 14R6 and 19R6 Motors	
	2105	Blower Intake Stack for 23R6	
36	1517	Starter Pulley - 14R6, 19R6 and 23R6 Motors	
37	1594	Starter Pulley Hex. Extension - 14R6, 19R6 and 23R6 Motors	
37A	1594-1	Starter Pulley Hex. Extension - 19AR6 Only	
38	2210	3/8" Street Elbow	
39	1510	Drain Plug	3/8" Pipe Plug

Not Used With New Style Motor Base Assembly (See Plate 12 Revised)



L

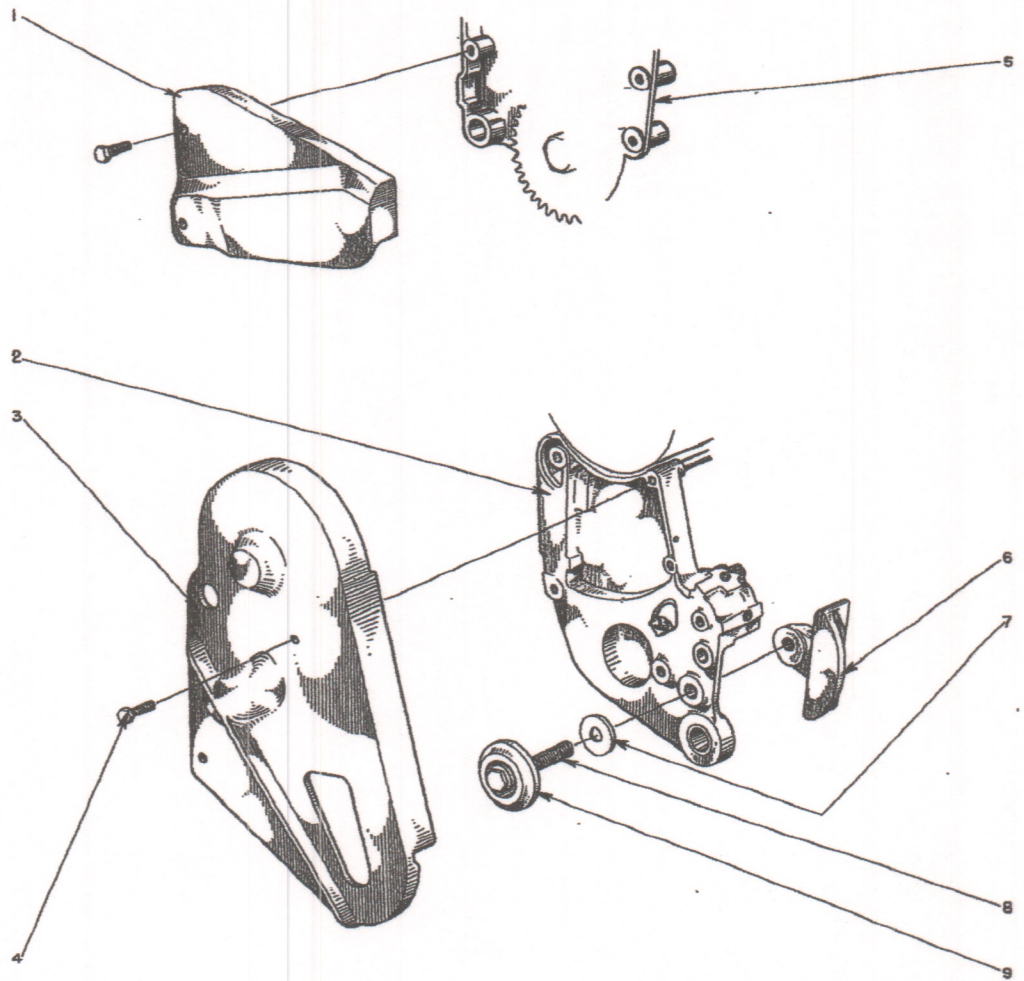

chain guards 25" & 30" - single unit with reverse

parts list number 12

KEY NO.	PART NO.	PART NAME	DESCRIPTION
1	1583	Tractor Chain Guard - Single Unit - Reverse Machine	
2	1577-S	Tractor Side Plate with Sway Control - Reverse Machine	
3	1590	Cutter Chain Guard - Single Unit - Reverse Machine	
4	892	Cap Screw	$\frac{3}{8}$ - 24 x 1 $\frac{1}{2}$ Hex. Head
5	1576-S	Tractor Side Plate with Sway Control - Reverse Machine	
6	1591	Cutter Chain Guard Single Unit - Reverse Machine	
7	778	Washer	1 1/8 x 33/64 x 1/8
8	2146	Cutter Chain Idler Stud 30" Reverse	
9	1059	Cutter Chain Idler Roll Assembly	

Parts Not Illustrated

1970	Sway Control Assembly Kit - 70" Reverse	
1971	Sway Control Assembly Kit - 75" Reverse	
2096	#514 Chain in 50 Foot Spools	$\frac{1}{2}$ P- $\frac{3}{4}$ W x .335 Roll
2101	#515 Chain in 50 Foot Spools	$\frac{1}{2}$ P- $\frac{5}{16}$ W x .335 Roll
2108	B & S 23AR6 Motor	
2113	25" 6 Blade Reel Assembly	
2114	30" 6 Blade Reel Assembly	
2135	Lip Blade - 25"	
2137	Lip Blade - 30"	
2138	Blade Back - 30"	
2139	Blade Back - 25"	
2140	Side Plate - R.H. (Close Cut)	
2141	Side Plate - L.H. (Close Cut)	
2152	Universal Drive Assembly	
2163	81351 B & S Engine	
2172	Universal Tension Spring	
2178	19R6 Motor	
2192	Screw Driver (Reed & Prince Recessed Head)	
2205	Side Unit Deflector	
2208	Topper for Sulky Seat	
2209	Height Micrometer Adjusting Assembly	
2219	25" Cutting Reel Assembly	
2220	30" Cutting Reel Assembly	
2221	Green Paint Spray Can	
2222	Grass Box for Side Units	
2223	Grass Box Cup Shoe	
2224	Grass Box Carrier Bracket - Inside	
2225	Grass Box Carrier Bracket - Outside	
2226	Grass Box Deflector	
2227	B & S Motor 19DR6	
2247	Motor Chain #60 x 33"	
2247-1	Motor Chain #60 x 33 $\frac{3}{4}$ " used with 25T Motor Sprocket	
2248	Motor Chain #60 x 34 $\frac{1}{2}$ " used with 23AR6 Motor	
2284	25" 7 Blade Reel Assembly	
2285	30" 7 Blade Reel Assembly	

